

$d_1 = 14...30$

$d_1 = 40$

$d_1 = 55$

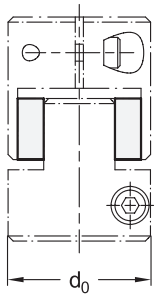
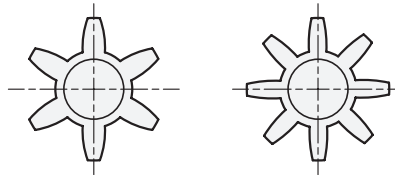
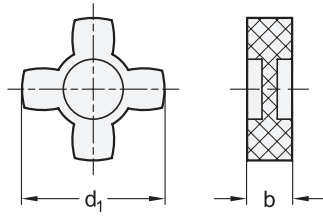

Assembly instruction

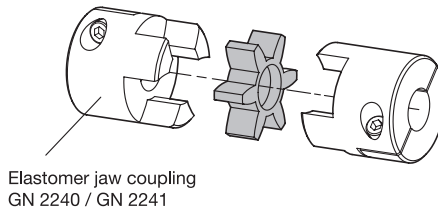

d_0 Coupling Ø GN 2240 / GN 2241	d_1	b	Number of teeth
14	14	6	4
20	20	8	4
30	30	10	4
40	40	12	6
55	55	14	8

Specification

- Polyurethane (TPU)
temperature resistant up to 60 °C
- Hardness
- 80 Shore A, blue
- 92 Shore A, white
- 98 Shore A, red

BS
WS
RS

- *Elastomer characteristics*
→ Main Catalogue Page 1483
- **RoHS**



Information

Coupling spiders GN 2240.1 are intended as replacement parts or for adjusting elastomer jaw couplings GN 2240 / GN 2241.

The choice of three coupling spiders with different hardness values allows the properties of the coupling to be optimally matched to the specific requirements.

see also...

- *Elastomer jaw couplings GN 2240 (clamping hub)* → Page 8
- *Elastomer jaw couplings GN 2241 (with grub screw)* → Page 10

How to order

GN 2240.1-40-RS

- | | |
|---|----------|
| 1 | d_1 |
| 2 | Hardness |