

Type A

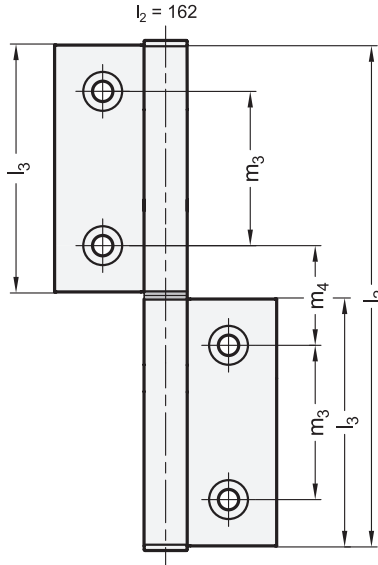

3 Type

- A exterior hinge wings
- I interior hinge wings

4 Identification no.

- C with countersunk holes

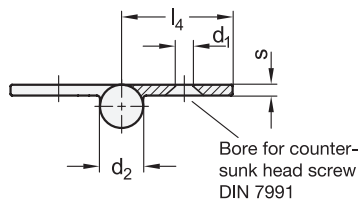

Type I

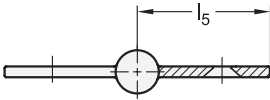

Assembly instruction

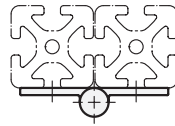

Type A

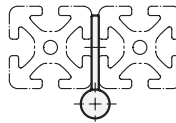

Type I

1		2											
l_1		l_2	d_1	d_2	l_3	l_4	l_5	m_1		m_2	m_3	m_4	s
Type A	Type I							Type A	Type I				
72	86	82	6,6	14	40	36	43	40,8	55	42	-	-	3,5
72	86	162	6,6	14	80	36	43	40,8	55	-	32	50	3,5

Specification

- Aluminum anodized, natural color **EL**
- Bearing bushing / cover cap
 - Plastic Technopolymer (Polyamide PA)
 - gray, RAL 7035
- Tapered dowel pin ISO 8741 Steel zinc plated, blue passivated
- Plastic characteristics → Page 1483
- RoHS

On request

- other lengths and hole spacings
- other finishes

5

Information

GN 2294 Hinges are made of drawn profiled aluminum and are used on doors and covers, for example.

Given the external hinge wing, type A hinges allow mounting with a very small door gap. The type I is fastened in the door gap. The mounting screws are therefore inaccessible and hence protected from vandalism when the door is closed.

The hinges are delivered loose and must be mounted according to the accompanying instructions. Any hinge combination may be realized thanks to the modular design and available accessories.

How to order

1	l_1
2	l_2
3	Type
4	Identification no.
5	Finish

GN 2294-86-162-A-C-EL

