

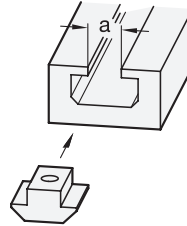

T-nuts to slide in

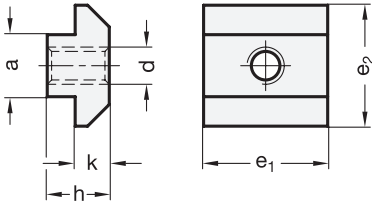

1 a <small>^{-0,1}_{-0,3}</small>	2 d				e₁	e₂	h	k <small>+0,1</small>
8	M 4	M 5	M 6	M 8	16	16	6	4,2
10	M 4	M 5	M 6	M 8	20	19,5	10,5	5,5

Specification

- Steel
zinc plated, blue passivated
- RoHS compliant

Information

T-Nuts GN 507 have been specially designed for use on extrusion rails. They are inserted from either end of the T-Slot.

see also...

- T-Nuts GN 506 / GN 506.1 (turnable) → Page 570

How to order

GN507-8-M6

1 a
2 d