

Plunger retracted

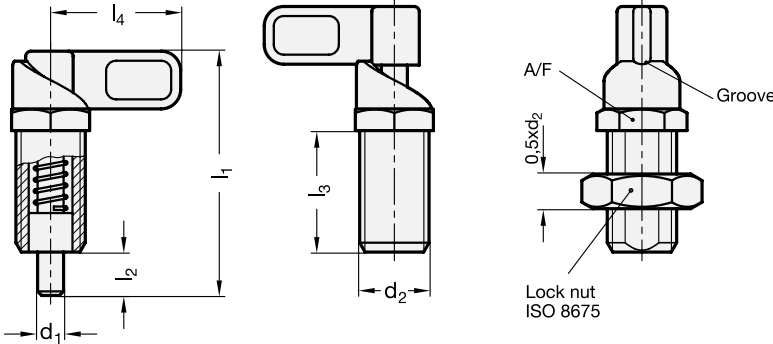

- 3** Type
A without lock nut
AK with lock nut

Mounting information

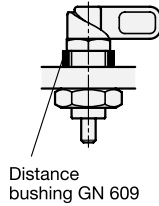

1 d_1 Plunger $-0,05$ Bore $+0,1$ $+0,05$	2 d_2	l_1	l_2	l_3	l_4	A/F	Spring load in N \approx	
							initial	end
4	M 12 x 1,5	48	8	25	25	13	8	22
5	M 12 x 1,5	48	8	25	25	13	8	22
6	M 12 x 1,5	48	8	25	25	13	8	22
6	M 16 x 1,5	56,5	10	28	30	18	11	30
8	M 16 x 1,5	56,5	10	28	30	18	11	30
8	M 20 x 1,5	69,5	12	36	37	22	20	56
10	M 16 x 1,5	56,5	10	28	30	18	11	30
10	M 20 x 1,5	69,5	12	36	37	22	20	56
12	M 20 x 1,5	69,5	12	36	37	22	20	56

Specification

- Threaded body
Zinc die casting
- corrosion-resistant
 ZNDG Pass nano®-coating
- anthracite
- Plunger
Steel
zinc plated, blue passivated
- Lever
Plastic (Polyamide PA)
- black, matt
- not removable
- Plastic characteristics → Page 1141
- RoHS compliant

Information

Cam action indexing plungers GN 612.8 are used in cases where the locking pin must not protrude all the time. By rotating the lock through 180° the locking pin withdraws itself. The notch allows safe positioning.

These cam action indexing plungers made of zinc die casting are very reasonably priced design versions.

see also...

- Range of cam action indexing plungers → Page 412
- Mounting blocks GN 612.1 → Page 453
- Mounting blocks GN 412.1 → Page 452
- Distance bushings GN 609 → Page 450
- Hexagonal nuts GN 909 → Page 451

How to order	1 d_1
1	d_1
2	d_2
3	Type
GN612.8-8-M16x1,5-A	