

Counterbored  
for cap screw  
DIN 912-M5 / M6

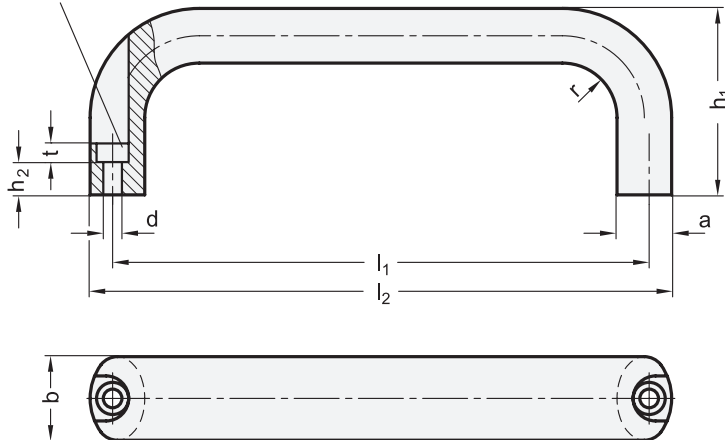

1

2

b	$l_1 \pm 0,25$	a	d	$h_1$	$h_2$	$l_2$	r	t
20	100	13	5,4	49	13,5	112	13	5,5
20	112	13	5,4	49	13,5	124	13	5,5
20	120	13	5,4	51	13,5	132	13	5,5
20	128	13	5,4	51	13,5	140	13	5,5
20	160	13	5,4	51	13,5	172	13	5,5
26	116	17	6,4	55	11	130	17	6
26	120	17	6,4	55	11	134	17	6
26	132	17	6,4	55	11	146	17	6
26	164	17	6,4	57	11	178	17	6
26	179	17	6,4	57	11	193	17	6
26	196	17	6,4	57	11	210	17	6

## Specification

- Aluminium
  - plastic coated
  - black, RAL 9005, textured finish
  - black, RAL 9005, textured finish UV-resistant
  - red, RAL 3000, textured finish
  - silver, RAL 9006, textured finish
  - anodized, natural colour
  - blank
  - tumbled

- SW
- SWU
- RS
- SR
- EL
- BL

• Load rating information → Page 342

• RoHS compliant

3

## Information

GN 565.1 cabinet „U“ handles are made from a bent aluminum profile and have excellent stability and ergonomic design. Due to the production process, special designs can be supplied even in relatively small quantities. In addition to the standard surfaces, these cabinet „U“ handles are also available with a functional coating.

The **SWU** version is coated with a highly weather-resistant and UV-protective powder coating system, making this version excellent for outdoor use.

see also...

• Assembly sets for profile systems GN 965 → Page 148

• Assembly sets for profile systems GN 968 → Page 156

How to order

GN 565.1-26-132-SW

1	b
2	$l_1$
3	Finish