

- 1
- 2
- 3
- 4
- 5
- 6
- 7
- 8
- 9
- 10
- 11
- 12
- 13
- 14
- 15
- RH
- 

**VIBRATION-DAMPING BODY**

Natural rubber NR, black colour.  
Hardness 40, 55, 70 Shore A  $\pm 5$ .

**STANDARD EXECUTIONS**

- **DVB.6**: zinc-plated steel plate and threaded stud.
- **DVB.6-SST**: AISI 304 stainless steel plate and threaded stud.
- **DVB.7**: zinc-plated steel plate and boss, threaded blind hole.
- **DVB.7-SST**: AISI 304 stainless steel plate and boss, threaded blind hole.

**FEATURES AND APPLICATIONS**

DVB. vibration-damping elements have been designed to damp vibrations, shocks and noises produced by moving bodies or non-balanced vibrating masses of equipment and machines.

DVB elements are generally used as a bumper or as a limit stop for the absorption of vibrations.

Vibrations can cause:

- malfunctioning and reduction of the machine lifespan and/or of the adjacent ones;
- damage to operator's health;
- noise.

See Technical data and guidelines for the choice.

**SPECIAL EXECUTIONS ON REQUEST**

Natural rubber NR, hardness 40, 70 Shore A  $\pm 5$  for the executions with AISI 304 stainless steel base.

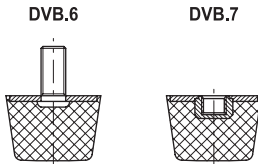

DVB.6

Code	Description	D	L	d	d1	l	Max load [N]	Max. deflection [mm]	Stiffness [N/mm]
432201	DVB.6-20-17-M5-6-40	20	17	M5	10	6	358	4.25	84
432001	DVB.6-20-17-M5-6-55	20	17	M5	10	6	407	4.25	96
432401	DVB.6-20-17-M5-6-70	20	17	M5	10	6	468	4.25	110
432202	DVB.6-20-17-M5-10-40	20	17	M5	10	10	358	4.25	84
432002	DVB.6-20-17-M5-10-55	20	17	M5	10	10	407	4.25	96
432402	DVB.6-20-17-M5-10-70	20	17	M5	10	10	468	4.25	110
432203	DVB.6-20-17-M5-20-40	20	17	M5	10	20	358	4.25	84
432003	DVB.6-20-17-M5-20-55	20	17	M5	10	20	407	4.25	96
432403	DVB.6-20-17-M5-20-70	20	17	M5	10	20	468	4.25	110
432211	DVB.6-20-17-M6-12-40	20	17	M6	10	12	358	4.25	84
432011	DVB.6-20-17-M6-12-55	20	17	M6	10	12	407	4.25	96
432411	DVB.6-20-17-M6-12-70	20	17	M6	10	12	468	4.25	110
432212	DVB.6-20-17-M6-18-40	20	17	M6	10	18	358	4.25	84
432012	DVB.6-20-17-M6-18-55	20	17	M6	10	18	407	4.25	96
432412	DVB.6-20-17-M6-18-70	20	17	M6	10	18	468	4.25	110
432213	DVB.6-20-17-M6-25-40	20	17	M6	10	25	358	4.25	84
432013	DVB.6-20-17-M6-25-55	20	17	M6	10	25	407	4.25	96
432413	DVB.6-20-17-M6-25-70	20	17	M6	10	25	468	4.25	110
432221	DVB.6-25-17-M6-8-40	25	17	M6	19	8	261	4.25	61
432021	DVB.6-25-17-M6-8-55	25	17	M6	19	8	293	4.25	69
432421	DVB.6-25-17-M6-8-70	25	17	M6	19	8	374	4.25	88
432222	DVB.6-25-17-M6-12-40	25	17	M6	19	12	261	4.25	61
432022	DVB.6-25-17-M6-12-55	25	17	M6	19	12	293	4.25	69
432422	DVB.6-25-17-M6-12-70	25	17	M6	19	12	374	4.25	88
432223	DVB.6-25-17-M6-18-40	25	17	M6	19	18	261	4.25	61
432023	DVB.6-25-17-M6-18-55	25	17	M6	19	18	293	4.25	69
432423	DVB.6-25-17-M6-18-70	25	17	M6	19	18	374	4.25	88
432224	DVB.6-25-17-M6-25-40	25	17	M6	19	25	261	4.25	61
432024	DVB.6-25-17-M6-25-55	25	17	M6	19	25	293	4.25	69
432424	DVB.6-25-17-M6-25-70	25	17	M6	19	25	374	4.25	88
432231	DVB.6-32-22-M8-10-40	32	22	M8	24	10	492	5.5	89
432031	DVB.6-32-22-M8-10-55	32	22	M8	24	10	638	5.5	116
432431	DVB.6-32-22-M8-10-70	32	22	M8	24	10	813	5.5	148
432232	DVB.6-32-22-M8-16-40	32	22	M8	24	16	492	5.5	89
432032	DVB.6-32-22-M8-16-55	32	22	M8	24	16	638	5.5	116
432432	DVB.6-32-22-M8-16-70	32	22	M8	24	16	813	5.5	148
432233	DVB.6-32-22-M8-23-40	32	22	M8	24	23	492	5.5	89
432033	DVB.6-32-22-M8-23-55	32	22	M8	24	23	638	5.5	116
432433	DVB.6-32-22-M8-23-70	32	22	M8	24	23	813	5.5	148
432234	DVB.6-32-22-M8-30-40	32	22	M8	24	30	492	5.5	89
432034	DVB.6-32-22-M8-30-55	32	22	M8	24	30	638	5.5	116
432434	DVB.6-32-22-M8-30-70	32	22	M8	24	30	813	5.5	148
432241	DVB.6-38-35-M8-10-40	38	35	M8	30	10	840	8.75	96
432041	DVB.6-38-35-M8-10-55	38	35	M8	30	10	1117	8.75	128
432441	DVB.6-38-35-M8-10-70	38	35	M8	30	10	1432	8.75	164
432242	DVB.6-38-35-M8-16-40	38	35	M8	30	16	840	8.75	96
432042	DVB.6-38-35-M8-16-55	38	35	M8	30	16	1117	8.75	128
432442	DVB.6-38-35-M8-16-70	38	35	M8	30	16	1432	8.75	164
432243	DVB.6-38-35-M8-30-40	38	35	M8	30	30	840	8.75	96
432043	DVB.6-38-35-M8-30-55	38	35	M8	30	30	1117	8.75	128

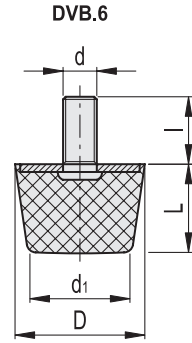

DVB.6 - 20 - 17 - M5 - 6 - 55  
 D L d l Shore A



Machine elements

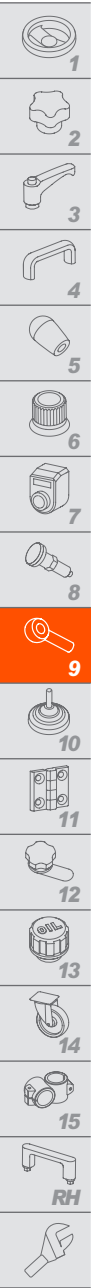

Machine elements

4

DVB.6

Code	Description	D	L	d	d1	l	Max load [N]	Max. deflection [mm]	Stiffness [N/mm]
432443	DVB.6-38-35-M8-30-70	38	35	M8	30	30	1432	8.75	164
432251	DVB.6-38-35-M10-12-40	38	35	M10	30	12	840	8.75	96
432051	DVB.6-38-35-M10-12-55	38	35	M10	30	12	1117	8.75	128
432451	DVB.6-38-35-M10-12-70	38	35	M10	30	12	1432	8.75	164
432252	DVB.6-38-35-M10-20-40	38	35	M10	30	20	840	8.75	96
432052	DVB.6-38-35-M10-20-55	38	35	M10	30	20	1117	8.75	128
432452	DVB.6-38-35-M10-20-70	38	35	M10	30	20	1432	8.75	164
432253	DVB.6-38-35-M10-28-40	38	35	M10	30	28	840	8.75	96
432053	DVB.6-38-35-M10-28-55	38	35	M10	30	28	1117	8.75	128
432453	DVB.6-38-35-M10-28-70	38	35	M10	30	28	1432	8.75	164
432254	DVB.6-38-35-M10-40-40	38	35	M10	30	40	840	8.75	96
432054	DVB.6-38-35-M10-40-55	38	35	M10	30	40	1117	8.75	128
432454	DVB.6-38-35-M10-40-70	38	35	M10	30	40	1432	8.75	164
432261	DVB.6-43-50-M10-12-40	43	50	M10	30	12	1027	12.5	82
432061	DVB.6-43-50-M10-12-55	43	50	M10	30	12	1523	12.5	122
432461	DVB.6-43-50-M10-12-70	43	50	M10	30	12	2009	12.5	161
432262	DVB.6-43-50-M10-20-40	43	50	M10	30	20	1027	12.5	82
432062	DVB.6-43-50-M10-20-55	43	50	M10	30	20	1523	12.5	122
432462	DVB.6-43-50-M10-20-70	43	50	M10	30	20	2009	12.5	161
432263	DVB.6-43-50-M10-28-40	43	50	M10	30	28	1027	12.5	82
432063	DVB.6-43-50-M10-28-55	43	50	M10	30	28	1523	12.5	122
432463	DVB.6-43-50-M10-28-70	43	50	M10	30	28	2009	12.5	161
432264	DVB.6-43-50-M10-40-40	43	50	M10	30	40	1027	12.5	82
432064	DVB.6-43-50-M10-40-55	43	50	M10	30	40	1523	12.5	122
432464	DVB.6-43-50-M10-40-70	43	50	M10	30	40	2009	12.5	161
432271	DVB.6-50-20-M10-12-40	50	20	M10	40	12	1843	5	369
432071	DVB.6-50-20-M10-12-55	50	20	M10	40	12	2310	5	462
432471	DVB.6-50-20-M10-12-70	50	20	M10	40	12	3007	5	601
432272	DVB.6-50-20-M10-20-40	50	20	M10	40	20	1843	5	369
432072	DVB.6-50-20-M10-20-55	50	20	M10	40	20	2310	5	462
432472	DVB.6-50-20-M10-20-70	50	20	M10	40	20	3007	5	601
432273	DVB.6-50-20-M10-28-40	50	20	M10	40	28	1843	5	369
432073	DVB.6-50-20-M10-28-55	50	20	M10	40	28	2310	5	462
432473	DVB.6-50-20-M10-28-70	50	20	M10	40	28	3007	5	601
432274	DVB.6-50-20-M10-40-40	50	20	M10	40	40	1843	5	369
432074	DVB.6-50-20-M10-40-55	50	20	M10	40	40	2310	5	462
432474	DVB.6-50-20-M10-40-70	50	20	M10	40	40	3007	5	601
432281	DVB.6-60-40-M10-12-40	60	40	M10	40	12	1652	10	165
432081	DVB.6-60-40-M10-12-55	60	40	M10	40	12	2090	10	209
432481	DVB.6-60-40-M10-12-70	60	40	M10	40	12	3258	10	326
432282	DVB.6-60-40-M10-20-40	60	40	M10	40	20	1652	10	165
432082	DVB.6-60-40-M10-20-55	60	40	M10	40	20	2090	10	209
432482	DVB.6-60-40-M10-20-70	60	40	M10	40	20	3258	10	326
432283	DVB.6-60-40-M10-28-40	60	40	M10	40	28	1652	10	165
432083	DVB.6-60-40-M10-28-55	60	40	M10	40	28	2090	10	209
432483	DVB.6-60-40-M10-28-70	60	40	M10	40	28	3258	10	326
432284	DVB.6-60-40-M10-40-40	60	40	M10	40	40	1652	10	165
432084	DVB.6-60-40-M10-40-55	60	40	M10	40	40	2090	10	209
432484	DVB.6-60-40-M10-40-70	60	40	M10	40	40	3258	10	326

DVB.6

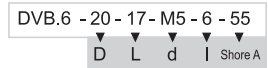
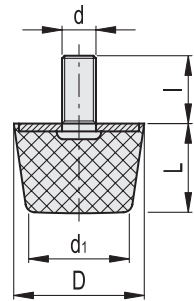

DVB.6-SST

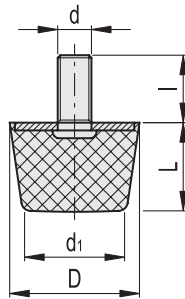

DVB.6 -20 - 17 - SST - M5 - 6 - 55  
 D L Stainless steel d l Shore A

DVB.6-SST

INOX STAINLESS STEEL

Code	Description	D	L	d	d1	l	Max load [N]	Max. deflection [mm]	Stiffness [N/mm]
432601	DVB.6-20-17-SST-M5-6-55	20	17	M5	10	6	407	4.25	96
432602	DVB.6-20-17-SST-M5-10-55	20	17	M5	10	10	407	4.25	96
432603	DVB.6-20-17-SST-M5-20-55	20	17	M5	10	20	407	4.25	96
432611	DVB.6-20-17-SST-M6-12-55	20	17	M6	10	18	407	4.25	96
432612	DVB.6-20-17-SST-M6-18-55	20	17	M6	10	18	407	4.25	96
432613	DVB.6-20-17-SST-M6-25-55	20	17	M6	10	25	407	4.25	96
432621	DVB.6-25-17-SST-M6-8-55	25	17	M6	19	8	293	4.25	69
432622	DVB.6-25-17-SST-M6-12-55	25	17	M6	19	12	293	4.25	69
432623	DVB.6-25-17-SST-M6-18-55	25	17	M6	19	18	293	4.25	69
432624	DVB.6-25-17-SST-M6-25-55	25	17	M6	19	25	293	4.25	69
432631	DVB.6-32-22-SST-M8-10-55	32	22	M8	24	10	638	5.5	116
432632	DVB.6-32-22-SST-M8-16-55	32	22	M8	24	16	638	5.5	116
432633	DVB.6-32-22-SST-M8-23-55	32	22	M8	24	23	638	5.5	116
432634	DVB.6-32-22-SST-M8-30-55	32	22	M8	24	30	638	5.5	116
432641	DVB.6-38-35-SST-M8-10-55	38	35	M8	30	10	1117	8.75	128
432642	DVB.6-38-35-SST-M8-16-55	38	35	M8	30	16	1117	8.75	128
432643	DVB.6-38-35-SST-M8-30-55	38	35	M8	30	30	1117	8.75	128
432651	DVB.6-38-35-SST-M10-12-55	38	35	M10	30	12	1117	8.75	128
432652	DVB.6-38-35-SST-M10-20-55	38	35	M10	30	20	1117	8.75	128
432653	DVB.6-38-35-SST-M10-28-55	38	35	M10	30	28	1117	8.75	128
432654	DVB.6-38-35-SST-M10-40-55	38	35	M10	30	40	1117	8.75	128
432661	DVB.6-43-50-SST-M10-12-55	43	50	M10	30	12	1523	12.5	122
432662	DVB.6-43-50-SST-M10-20-55	43	50	M10	30	20	1523	12.5	122
432663	DVB.6-43-50-SST-M10-28-55	43	50	M10	30	28	1523	12.5	122
432664	DVB.6-43-50-SST-M10-40-55	43	50	M10	30	40	1523	12.5	122
432671	DVB.6-50-20-SST-M10-12-55	50	20	M10	40	12	2310	5	462
432672	DVB.6-50-20-SST-M10-20-55	50	20	M10	40	20	2310	5	462
432673	DVB.6-50-20-SST-M10-28-55	50	20	M10	40	28	2310	5	462
432674	DVB.6-50-20-SST-M10-40-55	50	20	M10	40	40	2310	5	462
432681	DVB.6-60-40-SST-M10-12-55	60	40	M10	40	12	2090	10	209
432682	DVB.6-60-40-SST-M10-20-55	60	40	M10	40	20	2090	10	209
432683	DVB.6-60-40-SST-M10-28-55	60	40	M10	40	28	2090	10	209
432684	DVB.6-60-40-SST-M10-40-55	60	40	M10	40	40	2090	10	209



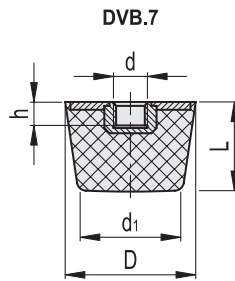
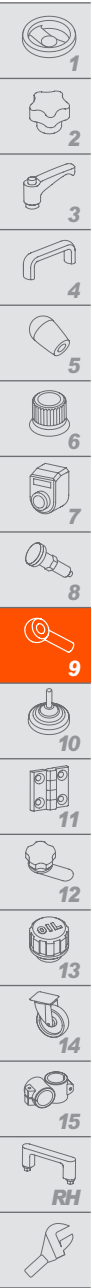

DVB.7 - 20 - 17 - M5 - 55  
 D L d Shore A

DVB.7

Code	Description	D	L	d	d1	h	Max load [N]	Max. deflection [mm]	Stiffness [N/mm]
432301	DVB.7-20-17-M5-40	20	17	M5	10	5	207	4.25	49
432101	DVB.7-20-17-M5-55	20	17	M5	10	5	253	4.25	60
432501	DVB.7-20-17-M5-70	20	17	M5	10	5	311	4.25	73
432302	DVB.7-20-17-M6-40	20	17	M6	10	6	207	4.25	49
432102	DVB.7-20-17-M6-55	20	17	M6	10	6	253	4.25	60
432502	DVB.7-20-17-M6-70	20	17	M6	10	6	311	4.25	73
432303	DVB.7-25-17-M6-40	25	17	M6	19	6	289	4.25	68
432103	DVB.7-25-17-M6-55	25	17	M6	19	6	358	4.25	84
432503	DVB.7-25-17-M6-70	25	17	M6	19	6	454	4.25	107
432311	DVB.7-32-22-M8-40	32	22	M8	24	8	411	5.5	75
432111	DVB.7-32-22-M8-55	32	22	M8	24	8	506	5.5	92
432511	DVB.7-32-22-M8-70	32	22	M8	24	8	673	5.5	122
432321	DVB.7-38-35-M8-40	38	35	M8	30	8	604	8.75	69
432121	DVB.7-38-35-M8-55	38	35	M8	30	8	893	8.75	102
432521	DVB.7-38-35-M8-70	38	35	M8	30	8	1104	8.75	126
432331	DVB.7-38-35-M10-40	38	35	M10	30	10	604	8.75	69
432131	DVB.7-38-35-M10-55	38	35	M10	30	10	893	8.75	102
432531	DVB.7-38-35-M10-70	38	35	M10	30	10	1104	8.75	126
432341	DVB.7-43-50-M10-40	43	50	M10	30	10	1327	12.5	106
432141	DVB.7-43-50-M10-55	43	50	M10	30	10	2011	12.5	161
432541	DVB.7-43-50-M10-70	43	50	M10	30	10	3027	12.5	242
432351	DVB.7-50-20-M10-40	50	20	M10	40	10	2763	5	553
432151	DVB.7-50-20-M10-55	50	20	M10	40	10	3570	5	714
432551	DVB.7-50-20-M10-70	50	20	M10	40	10	4875	5	975
432361	DVB.7-60-40-M10-40	60	40	M10	40	10	1685	10	169
432161	DVB.7-60-40-M10-55	60	40	M10	40	10	2101	10	210
432561	DVB.7-60-40-M10-70	60	40	M10	40	10	3231	10	323

Machine elements



DVB.7 - 20 - 17 - SST - M5 - 55  
 D L Stainless steel d Shore A

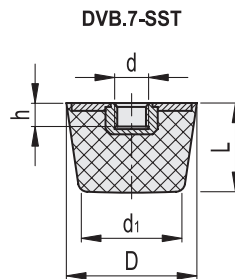

DVB.7-SST



Code	Description	D	L	d	d1	h	Max load [N]	Max. deflection [mm]	Stiffness [N/mm]
432701	DVB.7-20-17-SST-M5-55	20	17	M5	10	5	253	4.25	60
432702	DVB.7-20-17-SST-M6-55	20	17	M6	10	6	253	4.25	60
432703	DVB.7-25-17-SST-M6-55	25	17	M6	10	6	358	4.25	84
432711	DVB.7-32-22-SST-M8-55	32	22	M8	24	8	506	5.5	92
432721	DVB.7-38-35-SST-M8-55	38	35	M8	30	8	893	8.75	102
432731	DVB.7-38-35-SST-M10-55	38	35	M10	30	10	893	8.75	102
432741	DVB.7-43-50-SST-M10-55	43	50	M10	30	10	2011	12.5	161
432751	DVB.7-50-20-SST-M10-55	50	20	M10	40	10	3570	5	714
432761	DVB.7-60-40-SST-M10-55	60	40	M10	40	10	2101	10	210

Machine elements