

Range extended!

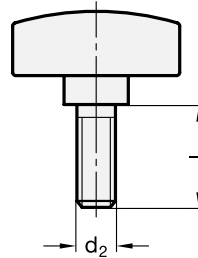
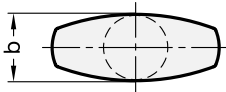
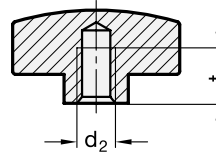
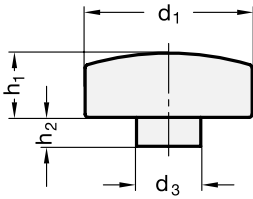

ROSTFREI
Inox
Stainless
Steel

1 d ₁	2 d ₂	3 Length l			d ₃	b	h ₁	h ₂	t min.
26	M 4	-	-	-	10	11	10	4,5	7
26	M 5	10	16	-	10	11	10	4,5	8
26	M 6	16	20	25	10	11	10	4,5	8
34	M 6	20	25	30	12	13	12	5	10
34	M 8	16	20	30	12	13	12	5	9

Specification

- Stainless Steel-Precision casting
- AISI CF-8
- matt shot-blasted **MT**
- Stainless Steel characteristics → Page 334
- RoHS compliant

4

Information

- see also...
- Stainless Steel-Wing nuts GN 834 (with bigger diameter d₁) → Main Catalogue Page 306
 - Stainless Steel-Wing screws GN 835 (with bigger diameter d₁) → Main Catalogue Page 307

Stainless Steel-Wing nut	1 d ₁
1 2 4	2 d ₂
GN 434-26-M6-MT	4 Finish

Stainless Steel-Wing screw	1 d ₁
1 2 3 4	2 d ₂
GN 433-34-M8-20-MT	3 Length l
	4 Finish