

- 1
- 2
- 3
- 4
- 5
- 6
- 7
- 8
- 9
- 10
- 11
- 12
- 13
- 14
- 15
- RH

MATERIAL

Glass-fibre reinforced polyamide based (PA) technopolymer, grey-black colour, matte finish.

HUB CAP

Glass-fibre reinforced polyamide based (PA) technopolymer, in Ergostyle colours, matte finish, press-fit assembly. Available also as accessory sold separately (see table ECM.).

Code	Description	Boss cap for
29633-*	ECM.K3-*	EKH.100
29634-*	ECM.K4-*	EKH.125

* Complete with colour index (C1, ..., C6).

STANDARD EXECUTION

Black-oxide steel hub, H7 reamed hole. Revolving handle l.621+x (see page 406) in technopolymer.

FEATURES AND APPLICATIONS

The reticular structure of the crank arm and the technopolymer used make this handle very strong and therefore suitable for transmitting high torque values.

ACCESSORIES ON REQUEST





Axial retaining washer GN 184 (see page 677).

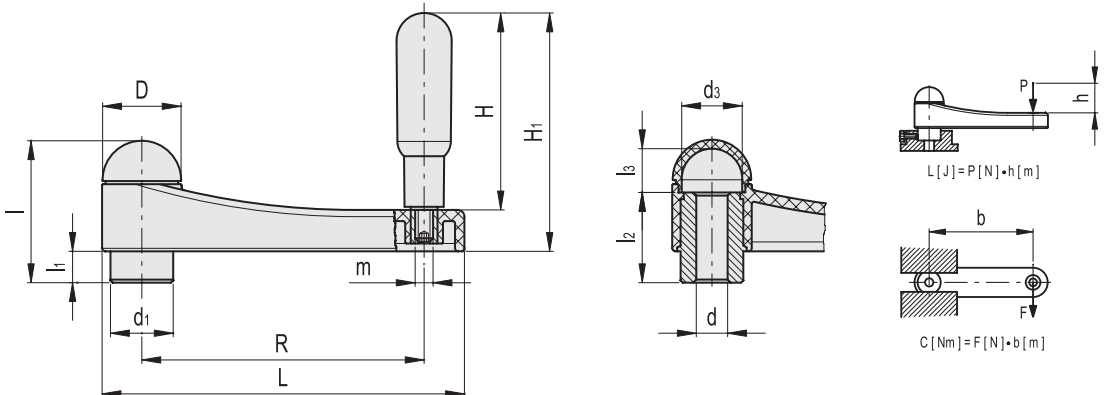

ELESA Original design **ERGOSTYLE®** stuttgart 

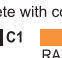

* Complete with colour index, example: 210241-C2 EKH.100 A-12-C2

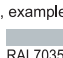
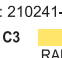
 C1 RAL7021	 C2 RAL2004	 C3 RAL7035	 C4 RAL1021	 C5 RAL5024	 C6 RAL3000
--	--	--	--	--	--

Code	Description	R	dH7	L	D	d1	d3	l	l1	l2	l3	H	H1	m	C# [Nm]	L# [J]	⚖
210241-*	EKH.100 A-12-*	101	12	131.5	30.5	24	23.5	52.5	10	33	17	65	81	M8	200	27	231
210251-*	EKH.125 A-14-*	126	14	161.5	35	28	26.5	62	14	40	18	80	98.5	M8	350	45	316

For maximum applicable torque (C) and impact strength (L) see Technical data on page A-3.