

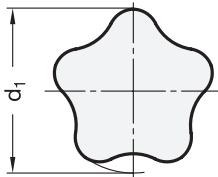

ROSTFREI  
Inox  
Stainless  
Steel

Inch  
sizes  
available

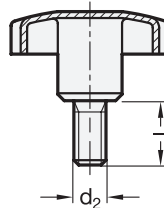
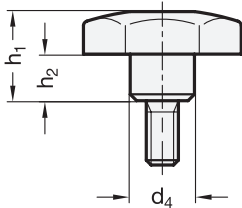

| <sup>1</sup> d <sub>1</sub> | <sup>2</sup> d <sub>2</sub> | <sup>3</sup> Length l | d <sub>4</sub> | h <sub>1</sub> ≈ | h <sub>2</sub> ≈ |
|-----------------------------|-----------------------------|-----------------------|----------------|------------------|------------------|
| 40                          | M 8                         | 20 30 40              | -              | 14               | 24 12            |
| 50                          | M 10                        | 20 30 40              | -              | 18               | 30 16,5          |
| 60                          | M 12                        | 20 30 40 50           | 20             | 37,5             | 20               |

**Specification**

- **GN 5334**  
Stainless Steel AISI 304 (A2)
  - **GN 5334.4**  
Stainless Steel AISI 316L (A4)
- This information applies to both standards:
- Knob drawn from Stainless Steel-sheet
  - Hub with threaded bolt welded
  - matt shot-blasted
  - *Stainless Steel characteristics* → Page 334
  - **RoHS compliant**

**Information**

The original ELESA design with 5 recess grips is typical for GN 5334 star knobs.

This form gives these grips an appealing look and additionally allows a high torque to be achieved.

see also...

- *Stainless Steel-Wing screws GN 835* → Main Catalogue Page 307
- *Stainless Steel-Knurled screws GN 535* → Main Catalogue Page 321

|  |                  |
|--|------------------|
| How to order (Stainless Steel AISI 303, A2)                        | 1 d <sub>1</sub> |
| <sup>1</sup> <sup>2</sup> <sup>3</sup><br><b>GN 5334-50-M10-40</b> | 2 d <sub>2</sub> |
|  | 3 Length l       |

|  |                  |
|--|------------------|
| How to order (Stainless Steel AISI 316L, A4)                         | 1 d <sub>1</sub> |
| <sup>1</sup> <sup>2</sup> <sup>3</sup><br><b>GN 5334.4-60-M12-30</b> | 2 d <sub>2</sub> |
|  | 3 Length l       |