



**MATERIAL**

Glass-fibre reinforced polyamide based (PA) technopolymer, black colour, matte finish.

**STANDARD EXECUTIONS**

- **SC.GXX2**: two sets of dimples on the bottom of the housing (to drill according to the type of indicator) and two supplied M4x10 countersunk head screws.
- **SC.GXX5**: two holes for supplied M4x10 countersunk head screws.

**APPLICATIONS**

SC-XX indicator housings are suitable with gravity indicators on any handwheel or other control devices.



SC.GXX2

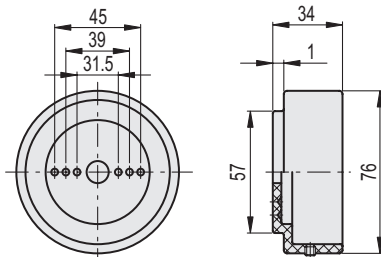

SC.GXX5

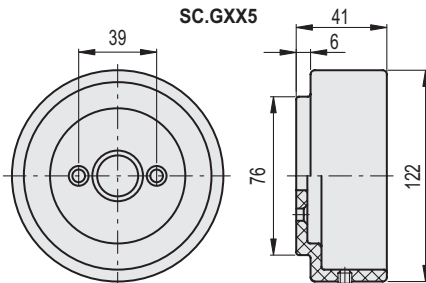

Code	Description	⚖️	Indicator combinations
CE.40002	SC.GXX2	72	GA02 - GA12 - GW12
CE.40005	SC.GXX5	191	GA05

Position indicators