

# GN 417 Indexing plungers

with rest position



Range extended!

Plunger in rest position



**2** Type

C with rest position (Knob)

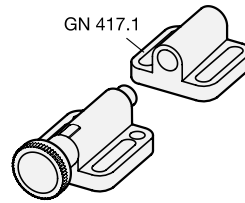
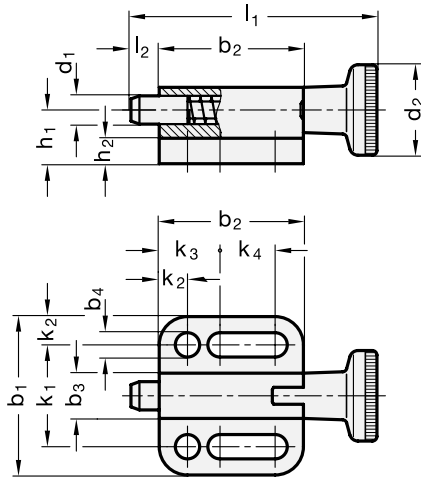

d <sub>1</sub> Plunger h11 Bore $\begin{smallmatrix} +0,03 \\ -0,08 \end{smallmatrix}$	d <sub>2</sub>	b <sub>1</sub>	b <sub>2</sub>	b <sub>3</sub>	b <sub>4</sub> -0,2	h <sub>1</sub>	h <sub>2</sub>	k <sub>1</sub> ±0,05	k <sub>2</sub>	k <sub>3</sub>	k <sub>4</sub>	l <sub>1</sub>	l <sub>2</sub> min.	Spring load in N ≈	
														initial	end
4	12	22	19	6	3,3	7	4	14	4	8	7	33	4	3	12
5	16	28	25,5	8	4,3	9,5	4,5	18	5	10	10,5	43,5	5	5	24
6	18	32	30,5	10	5,4	10,5	5	21	5,5	12	13	52	6	5	21
8	21	34	37,5	12	5,4	12,5	6	23	5,5	12	20	63,5	8	6	22
10	25	39	40	14,5	6,5	14,5	6	27	6	15	18,5	72,5	10	4	25

## Specification

- Guide  
Zinc die casting  
plastic coated  
black, textured finish
- Plunger  
Stainless Steel AISI 303
- Spring  
Stainless Steel AISI 301
- Knob  
Plastic Technopolymer (Polyamide PA)  
- black, matt  
- not removable
- ISO-Fundamental Tolerances → Page 323
- Stainless Steel characteristics → Page 334
- Plastic characteristics → Page 331
- RoHS compliant

## Information

Indexing plungers GN 417 type C with rest position are used for such applications where the plunger has to stay in its retracted position. To achieve this, the knob is rotated by 90° degrees after being retracted. A notch keeps the plunger in this position.

The screwing range is chosen in such a way that washers ISO 7092 can be used.

see also...

- Range of indexing plungers → Main Catalogue Page 402/411
- Positioning bushings GN 412.2 → Main Catalogue Page 454
- Locators GN 417.1 → Page 120

How to order

GN417-8-C

1 d<sub>1</sub>

2 Type