

Cast hexagonal socket for hexagon nut d_3

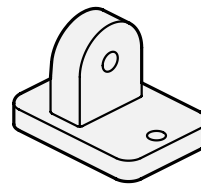
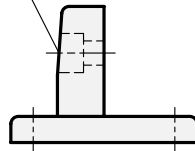

1

b Swivel width	d ₁	d ₂	d ₃	Length l	m ₁	m ₂	t ₁	t ₂	s	x ₁	x ₂	y
25	6,5	5,5	M 6	36,5	24	25	12,5	7	10	50	38	35

Specification

- Aluminium
 - plastic coated black, RAL 9005, textured finish
 - blank matt shot-blasted

- SW
- BL

• RoHS compliant

2

Information

Swivel clamp connector bases GN 271 can be assembled with the swivel clamp connectors GN 273, GN 275 or GN 277 to create swivel clamp connector joints.

see also...

- Swivel clamp connector joints GN 281 (Connection of GN 271 with GN 275) → Page 1015
- Sensor holders GN 271.4 → Page 1055

How to order

GN 271-25-SW

1	b
2	Finish