

Inch sizes available

3 Identification No.
2 with Stainless Steel-Clamping screw DIN 912

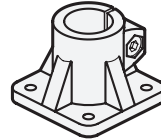

1 **2**

d_1 Bore B	k Clamping length	d_2	d_3 Clamping thread	l_1	l_2	t	x_1	x_2	y_1	y_2	Clamping kits for d_3
B 20	50	6,5	M 8	52	40	7	60	42	60	42	GN 911-M 8-32
B 25	50	6,5	M 8	52	40	7	60	42	60	42	GN 911-M 8-32
B 30	50	6,5	M 8	52	40	7	60	42	60	42	GN 911-M 8-32
B 30	70	8,5	M 10	68	56	10	90	64	90	64	GN 911-M10-40
B 32	70	8,5	M 10	68	56	10	90	64	90	64	GN 911-M10-40
B 35	70	8,5	M 10	68	56	10	90	64	90	64	GN 911-M10-40
B 40	70	8,5	M 10	68	56	10	90	64	90	64	GN 911-M10-40
B 40	85	11	M 10	77,5	65	14	105	74	105	74	GN 911-M10-55
B 42	85	11	M 10	77,5	65	14	105	74	105	74	GN 911-M10-55
B 45	85	11	M 10	77,5	65	14	105	74	105	74	GN 911-M10-55
B 48	85	11	M 10	77,5	65	14	105	74	105	74	GN 911-M10-55
B 50	85	11	M 10	77,5	65	14	105	74	105	74	GN 911-M10-55
B 55	100	11	M 10	92	80	14	125	89	125	89	GN 911-M10-55
B 60	100	11	M 10	92	80	14	125	89	125	89	GN 911-M10-55

Specification

- Aluminum
 - plastic coated black, RAL 9005, textured finish **● SW**
 - blank matt shot-blasted **○ BL**
- Clamping bores mechanically machined
- Socket cap screws DIN 912
Stainless Steel AISI 304
- Hexagon nuts DIN 985
Stainless Steel AISI 304
- Stainless Steel characteristics → Page 1144
- RoHS compliant

Accessory

- Clamping kits GN 911 → Page 1031

4

Information

The clamping bores of GN 163 base plate connector clamps are mechanically machined and specially designed for construction tubes GN 990 or DIN 2391, DIN 2395 and DIN 2462 respectively.

The standard version of the clamping screw is a socket cap screw with hexagonal socket DIN 912. It can be replaced by a clamping kit GN 911 (article code see table of dimensions).

see also...

- Construction tubes GN 990 → Page 1027
- Base plate linear actuator connectors GN 163.1 → Page 1051

How to order

GN 163-B40-85-2-BL

1	d_1
2	k
3	Identification No.
4	Finish