

**2 Identification No.**  
 2 with Stainless Steel-Clamping screw DIN 912

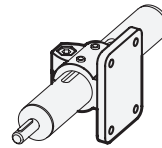

**1**

d <sub>1</sub>	d <sub>2</sub>	d <sub>3</sub>	d <sub>4</sub>	k	Length l	m	t	x <sub>1</sub>	x <sub>2</sub>	y <sub>1</sub>	y <sub>2</sub>	Clamping kit for d <sub>3</sub>	
Bore B without slide bushing	Bore G with slide bushing	Clamping thread	Mounting screw on the follower	Clamping length									
B 30	G 30	6,5	M 8	M 4	40	62	30	7	52	35	70	53	GN 911-M 8-32
B 40	G 40	8,5	M 10	M 5	56	83	42	10	78	52	108	82	GN 911-M10-40
B 50	G 50	11	M 10	M 6	65	95	50	14	92	62	128	98	GN 911-M10-55
B 60	G 60	11	M 10	M 8	80	112	60	14	110	74	154	118	GN 911-M10-55

**Specification**

- Aluminium plastic coated black, RAL 9005, textured finish **● SW**
- Guide bore mechanically machined
- Slide bushing Polyamide
- Socket cap screws DIN 912 Stainless Steel AISI 304
- Hexagon nuts DIN 985 Stainless Steel AISI 304
- Stainless Steel characteristics → Page 1144
- RoHS compliant

**Accessory**

- Clamping kits GN 911 → Page 1031

**3**

**Information**

GN 146.1 linear actuator connectors are normally supplied **mounted** only in connection with a linear actuator and for function control.

By means of the clamping screw on the guide bore d<sub>1</sub> the movement can either be set or the linear actuator connector can be clamped (after setting of final adjustment).

The standard version of the clamping screw is a socket cap screw with hexagonal socket DIN 912. It can be replaced by a clamping kit GN 911 (article code see table of dimensions).

see also...

- Linear actuators GN 291 → Page 1036
- Linear actuators GN 292 → Page 1038
- Linear actuators GN 293 → Page 1039

**How to order**

**GN 146.1-G50-2-SW**

<b>1</b>	d <sub>1</sub>
<b>2</b>	Identification No.
<b>3</b>	Finish