

- 1
- 2
- 3
- 4
- 5
- 6
- 7
- 8
- 9
- 10
- 11
- 12
- 13
- 14
- 15
- RH

COVERING

Grey anti-trace thermoplastic wheel, hardness 85 Shore A.

WHEEL CENTRE BODY

Polypropylene-based (PP) technopolymer.

ROLLING ACTION

Hub with pass-through hole.

APPLICATIONS

Excellent rolling resistance and elasticity features. For selection parameters see Technical data.

RE.G1 wheels are also supplied with steel sheet bracket RE.G1-N.

ENVIRONMENTAL CONDITIONS

Suitable for use in humid environments and in the presence of medium-aggressive chemical environments; use in environments with the presence of organic, chlorinated solvents, hydrocarbons and mineral oils is not recommended.

ROLLING RESISTANCE - FORCE / LOAD APPLIED

The diagram shows the force to be applied to a wheel to keep it moving at the constant speed of 4 km/h, according to the applied load.

The intersection point with a 50N value is the maximum transportable load with a manually actuated 4-wheel trolley; in fact, 200N = 50N x 4 wheels is the maximum force that may be supported by the operator according to the regulations in force regarding work safety.

MECHANICAL MOVING WITH TOWING DEVICES

For mechanical towing, please see the technical specifications to determine the capacity variation.

TEMPERATURE

If operating temperatures in an application differ from the standard range of values, please see the technical specifications to determine the capacity variation.

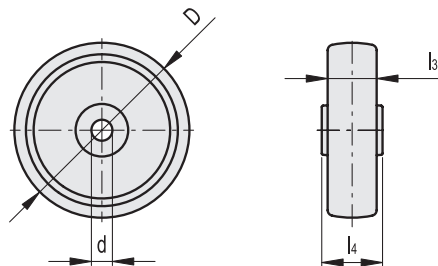
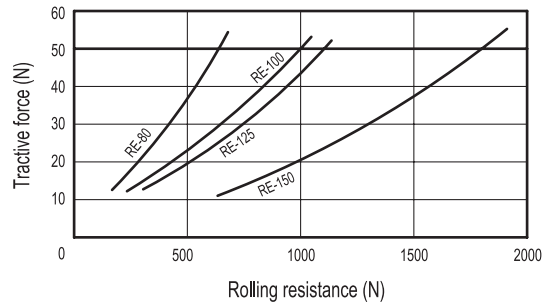

Code	Description	D	d	l3	l4	Static load# [N]	Rolling resistance# [N]	Dynamic carrying capacity# [N]	
452501	RE.G1-080-RBL	80	12	30	39	1000	700	700	90
452506	RE.G1-100-RBL	100	12	30	44	1500	1000	1000	120
452511	RE.G1-125-RBL	125	15	35	44	1800	1200	1200	200
452516	RE.G1-150-RBL	150	20	45	59	2700	1800	1800	360

For static load, rolling resistance and dynamic carrying capacity see Technical data.