



**MATERIAL**

Transparent polyamide based (PA-T) technopolymer. Avoid contact with alcohol or detergents containing alcohol.

The window consists of a continuous series of prisms which provide a clear and immediate reading of the level of the oil contained in the reservoir.

**PACKING RING**

NBR synthetic rubber.

**MAXIMUM CONTINUOUS WORKING TEMPERATURE**

100°C.

**TECHNICAL DATA**

The tightening torque indicated in the table guarantees an optimal tightness, keeping the packing ring in the correct position.

**NOTE**

For use with other fluids with special additives, please contact ELESA Sales Department.

**ACCESSORIES ON REQUEST**

Brass nut type GH. (see page 1201) for fitting to reservoirs with wall thickness smaller than 5 mm.



ELESA Original design

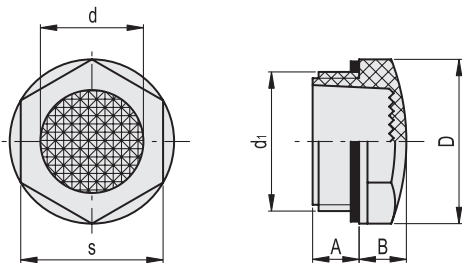

Code	Description	d1	A	B	D	d	s	Tightening torque [Nm]	⚖️
13652	HFTX.9/PR-1/4	G 1/4	10	6	18	9	15	2+3	3
13672	HFTX.12/PR-3/8	G 3/8	7.5	7	22	11	19	3+5	4
13692	HFTX.15/PR-1/2	G 1/2	10.5	8	26	14	22	4+6	5
13722	HFTX.20/PR-3/4	G 3/4	10.5	9	31.5	20	27	6+8	8
13742	HFTX.24/PR-1	G 1	11	10	40	25	34	8+10	12



Accessories for hydraulics