

MATERIAL

Polyamide based (PA) technopolymer.

- Cover: RAL 2004 orange, semi-matte finish, marked "OIL".
- Threaded connector: black colour, semi-matte finish.

PACKING RING

NBR synthetic rubber.

FLAT DIPSTICK

Flat section phosphatised steel.

On request and for sufficient quantities dipstick can be supplied in different lengths and/or complete with MAX-MIN level lines.

SPLASH GUARD

Technopolymer.

ATEX DIRECTIVE COMPLIANCE

The breather caps of the SFP+a-EX series comply with Health and Safety Requirements intended in 94/9/EC ATEX European Directive (explosive atmospheres) for equipments in Group II, category 2GD.

II 2 G D IIB T6, marked on the SFP-EX breather caps, represents the identification according to ATEX directive.

II: group of substances for which the product is suitable

2: identification of the category

G: identification of the type of explosive atmosphere (Gases or vapours)

D: identification of the type of explosive atmosphere (Dust)

IIB: group of explosive gases

T6: temperature class

Ambient and/or fluid temperature: -30 ± +80°C

Every product codes will be supplied with declaration of conformity to European Directives.

FEATURES AND APPLICATIONS

SFP+a-EX breather caps come complete with splash guard device (ELESA original design) that prevents oil loss and are particularly suitable for use where oil is violently agitated and could be splashed against breather cap.

TECHNICAL DATA

Air flow rate for each model can be determined from the graph calculating the difference between the pressure inside and outside the reservoir.



ELESA Original design 

Operating layout

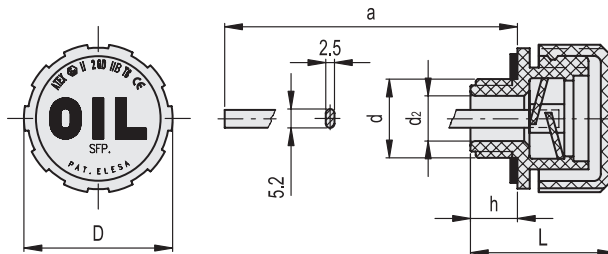
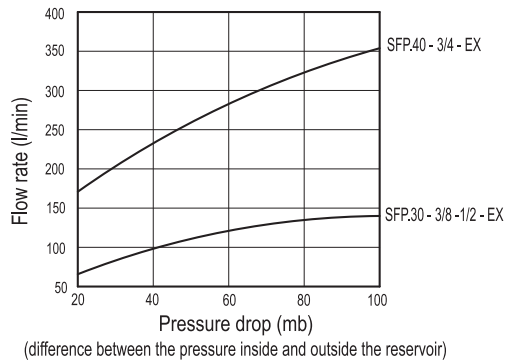
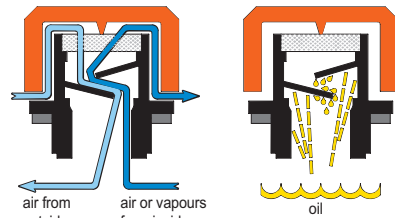

Code	Description	d	D	L	d2	h	a	⚖
54011-EX	SFP.30-3/8+a-EX	G 3/8	31	29.5	10	9.5	188	30
54111-EX	SFP.30-1/2+a-EX	G 1/2	31	29.5	12	9.5	188	30
54211-EX	SFP.40-3/4+a-EX	G 3/4	42	36.5	18	11.5	184	42

- 1 
- 2 
- 3 
- 4 
- 5 
- 6 
- 7 
- 8 
- 9 
- 10 
- 11 
- 12 
- 13 
- 14 
- 15 
- RH 