

T.470 | Plugs

Technopolymer



MATERIAL

Polyamide based (PA) technopolymer, black colour, matte finish.

PACKING RING

NBR synthetic rubber.

MAXIMUM CONTINUOUS WORKING TEMPERATURE

100°C.

SPECIAL EXECUTIONS ON REQUEST

Words, marks and graphic symbols can be tampprinted on the cap.



ELESA Original design

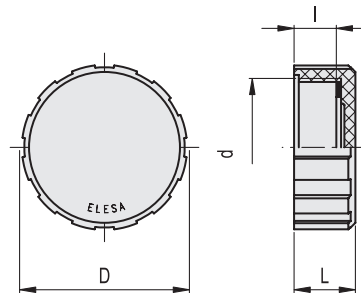

Code	Description	d	l	D	L	⚖️
58231	T.470-60x2	M60x2	18	70	26	55
58251	T.470-1	G 1	11	42	16	17
58281	T.470-2	G 2	18	70	26	58



Accessories for hydraulics