

2 Type
EP solid clamping arm, weldable

3 Coding
M Magnetic piston

1

Size	F _H in N Holding Capacity	F _S in N Clamping force at 6 bar ≈	b ₁	b ₂	b ₃	d ₁	d ₂	Inner diameter-Ø for hose	h ₁ ≈	h ₂
1000	10000	2500	102	90	20	10,5	G1/4	8	145	80
2000	20000	3600	112	100	20	10,5	G3/8	10	171,5	90

Size	h ₃	l ₁ ≈	l ₂ ≈	l ₃ ≈	m ₁	m ₂	m ₃	m ₄	r ≈	s
1000	25	410	90	155	65	12,5	65	48	140	13
2000	35	487	113	176	70	15	70	56	172	13

Specification

- Base
cast steel
black lacquered finish
- other parts
Steel St 60
zinc plated, blue passivated finish
- Bearing pins
case hardened
- Double-action air cylinder
with adjustable cushioning
max. pressure 6 bar
- All moving parts
lubricated with special grease
- **RoHS compliant**

Accessory

- Proximity switch with mounting bracket
GN 896.3 → Page 764

Information

Pneumatically operated clamps GN 861 have been constructed in such a way as to make them easy to unmount. The bearing pins are axially fixed with circlips. This allows the clamping arm to be modified to suit any particular application.

To ensure an extended life of the mechanical parts as well as the air cylinder the operating pressure should not exceed 6 bar. In addition a lubrication control unit should be fitted in the air line.

Pneumatically operated clamps GN 861 are also available as version M (magnetic piston). In conjunction with a proximity switch GN 896.3 the piston position is sensed and the generated signal can be used in sequence control systems.

see also...

- *More information for pneumatically operated clamps → Page 677*

How to order

GN861-1000-EP-M

- 1** Size
- 2** Type
- 3** Coding

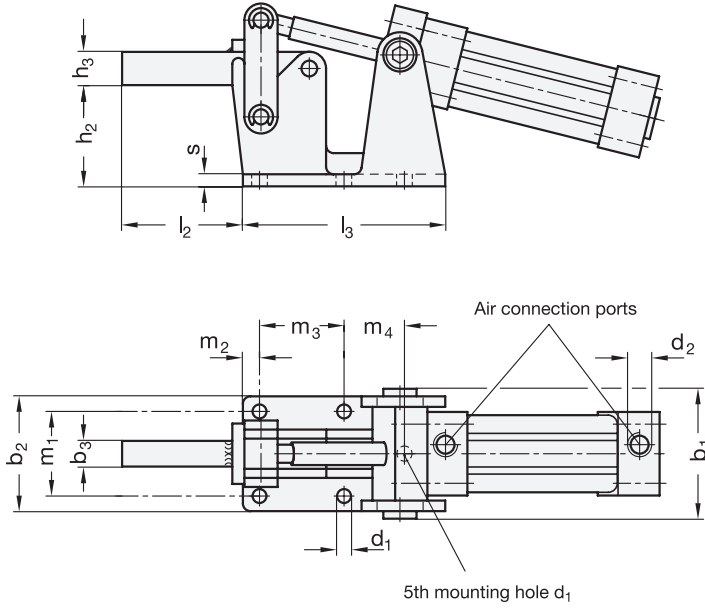

2.1

2.2

2.3

2.4

2.5

2.6

2.7

2.8

2.9

