

STC-A | Square tube connectors

with adjustable angle, technopolymer



CONNECTOR

Polyamide based (PA) technopolymer, black colour, matte finish.

STANDARD EXECUTIONS

- **2A-2W**: bidimensional two-way connector.
- **3A-3W**: tridimensional three-way connector.

FEATURES AND APPLICATIONS

Suitable for creating structures composed by square profiles. The assembly can be performed simply by positioning the connector, forcing it, inside the profile, with no need of screws or other fasteners.

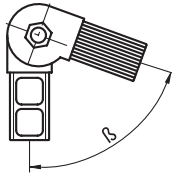

2A-2W

3A-3W

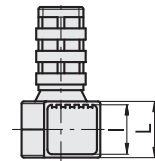
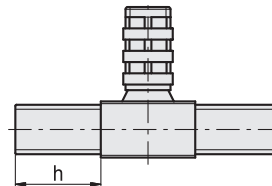
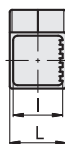
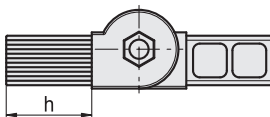

Code	Description	L	h	l	β min-max	Tube external diameter	Tube internal diameter	⚖
430003	STC.20-2A-2W-A-C9	20	35	17	0-190	20	17	54
430053	STC.25-2A-2W-A-C9	25	38	22	45-195	25	22	64
430103	STC.25-3A-3W-A-C9	25	38	22	45-195	25	22	85



Leveling elements and supports