

Cut-in for the retaining ring

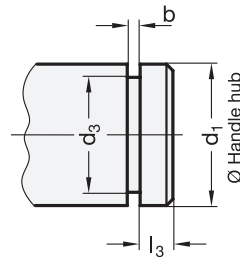

ROSTFREI  
Inox  
Stainless  
Steel

The retaining rings are to be mounted in direction as shown in the drawing

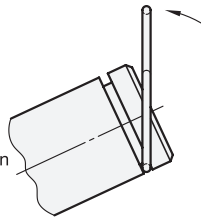

d <sub>1</sub>	d <sub>2</sub>	d <sub>3</sub> -0,1	b +0,2	l <sub>1</sub>	l <sub>2</sub>	l <sub>3</sub> +0,3
12	1,4	9,1	1,7	16	5,6	2,5
14	1,5	10,9	1,8	17	6	3,2
15	1,5	11,9	1,8	17	6	3,2
16	1,5	12,9	1,8	17	6	3,2
17	1,6	13,7	1,9	19	6,4	3,9
18	1,6	14,7	1,9	19	6,4	3,9
19	1,6	15,7	1,9	19	6,4	3,9
20	1,6	16,7	1,9	19	6,4	3,9
21	1,7	17,5	2	20	6,8	5,1
22	1,7	18,5	2	20	6,8	5,1
23	1,7	19,5	2	20	6,8	5,1
24	1,7	20,5	2	20	6,8	5,1
26	1,8	22,3	2,1	21	7,2	5,4

**Specification**

- Stainless Steel  
AISI 301
- *Stainless Steel characteristics* → Page 334
- **RoHS compliant**

**Information**

Retaining rings GN 111.6 are normally used together with ball chains or retaining cables.

One typical application involves making e.g. knurled screws captive, for instance.

GN 111.7 (see technical data new products) lists all standard parts that can be delivered with loss protection (with cut-in and retaining ring).

Star knobs GN 6336.13 with loss protection are delivered as a complete standard part made up of hand knobs with cut-in and mounted retaining ring, with retaining cable or ball chain.

see also...

- *Ball chains GN 111 / GN 111.5* → Main catalogue Page 477
- *Retaining cables GN 111.2* → Main catalogue Page 478

How to order

**GN 111.6-12**

1 d<sub>1</sub>