

I.731+x | Revolving handles

Technopolymer



MATERIAL

Polyamide based (PA) technopolymer, black colour, matte finish.

STANDARD EXECUTION

Zinc-plated steel shank, hexagon socket at threaded end.

ERGONOMY

The grooves cut into the cylindrical surface allow an effective and ergonomic grip, though necessarily limited to the fingertips, due to the small size of the handle.



ELESA Original design

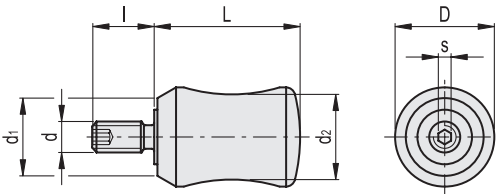

| Code | Description | D | L | d _{6g} | d ₁ | d ₂ | l | s | ⚖️ |
|-------|---------------|------|----|-----------------|----------------|----------------|----|-----|----|
| 24990 | I.731/20+x-M4 | 13.5 | 20 | M4 | 11 | 11 | 8 | 2 | 6 |
| 24991 | I.731/20+x-M5 | 13.5 | 20 | M5 | 11 | 11 | 10 | 2.5 | 9 |
| 24995 | I.731/23+x-M5 | 16 | 23 | M5 | 12.5 | 13 | 10 | 2.5 | 11 |

Fixed & revolving handles