



MATERIAL

High-resilience polypropylene based (PP) technopolymer, black colour, matte finish.

STANDARD EXECUTION

Blind hole.

The elastic coupling, by press-fit assembly on h9 tolerance drawn stock bars, is not affected by vibrations and prevents the handle from slipping off (see Technical data on page A-13).

ASSEMBLY INSTRUCTIONS

Fit the handle onto slight chamfered shaft end and push as far as possible by hand or by means of a small press. Alternatively it is possible to tap the handle with a plastic or wooden mallet until firmly in place. In this case we strongly recommend to use a cloth or other suitable soft material over the product to avoid any surface damage.

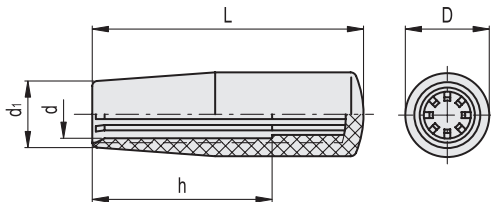

Code	Description	D	L	d	d1	h	⚖️
24821	1.580/40 N-8	18	40	8	15	28	8
24831	1.580/50 N-10	21	50	10	17	35	10
24846	1.580/65 N-10	23	65	10	19	45	17
24848	1.580/65 N-12*	23	65	12	19	45	16
24861	1.580/80 N-12	26	80	12	21	50	25
24863	1.580/80 N-14*	26	80	14	21	50	24
24875	1.580/90 N-15	28	90	15	22	60	33
24876	1.580/90 N-16*	28	90	16	22	60	32

* The assembly holes marked with * are cylindrical holes without fins.

