

**BASE**

- **DVA**: zinc-plated steel.
- **DVA-SST**: AISI 304 stainless steel.

**VIBRATION-DAMPING BODY**

Natural rubber NR, hardness 40, 55, 70 tolerance ±5 Shore A, black colour.

**STANDARD EXECUTIONS**

- **DVA.6**: zinc-plated steel threaded stud.
- **DVA.6-SST**: AISI 304 stainless steel threaded stud.
- **DVA.7**: zinc-plated steel boss, threaded blind hole.
- **DVA.7-SST**: AISI 304 stainless steel boss, threaded blind hole.

**FEATURES AND APPLICATIONS**

The vibration-damping elements have been designed to damp vibrations, shocks and noises produced by moving bodies or non-balanced vibrating masses of equipment and machines which can cause:

- malfunctioning and reduction of the machine lifespan and/or of the adjacent ones;
- damage to health;
- noise.

Load diagrams for each single code are available on request. See Technical data and guidelines for the choice (on page 728).

**SPECIAL EXECUTIONS ON REQUEST**

Natural rubber NR, hardness 40, 70 tolerance ±5 Shore A for executions with AISI 304 stainless steel base.



DVA.6  
DVA.6-SST

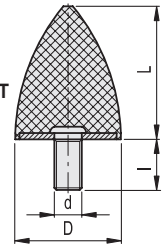

\* Complete the description with the desired hardness: 40, 55 or 70 tolerance ±5 Shore A.



Description	D	L	d	I	⚖	Hardness 40 Shore A			Hardness 55 Shore A			Hardness 70 Shore A					
						Code	Max load [N]	Max deflection [mm]	Stiffness [N/mm]	Code	Max load [N]	Max deflection [mm]	Stiffness [N/mm]	Code	Max load [N]	Max deflection [mm]	Stiffness [N/mm]
DVA.6-10-10-M5-12-*	10	10	M5	12	2	416991	46	3	14	413381	59	3	20	418791	113	3	40
DVA.6-20-15-M6-18-*	20	15	M6	18	9	416997	84	5	17	413397	194	4	48	418797	321	4	78
DVA.6-20-24-M6-18-*	20	24	M6	18	10	416101	82	6	14	413401	130	6	22	418801	330	6	55
DVA.6-25-20-M6-18-*	25	20	M6	18	15	416107	84	5	17	413407	190	5	38	418807	495	5	96
DVA.6-30-30-M8-18-*	30	30	M8	18	24	416111	190	8	25	413411	260	8	35	418811	630	8	84
DVA.6-30-36-M8-20-*	30	36	M8	20	39	416121	180	9	20	413421	320	9	36	418821	650	9	72
DVA.6-35-40-M8-23-*	35	40	M8	23	45	416131	260	10	26	413431	300	10	30	418831	630	10	63
DVA.6-50-50-M10-28-*	50	50	M10	28	110	416137	481	13	38	413437	740	13	59	418837	1656	13	132
DVA.6-50-61-M8-28-*	50	61	M8	28	114	416141	490	15	32	413441	600	15	39	418841	1520	15	100
DVA.6-50-68-M10-28-*	50	68	M10	28	131	416151	490	17	29	413451	890	17	52	418851	1950	17	115
DVA.6-70-58-M12-37-*	70	58	M12	37	258	416171	769	15	53	413471	1332	15	92	418871	1923	15	133
DVA.6-75-89-M12-37-*	75	89	M12	37	373	416181	971	22	44	413481	1680	22	76	418881	2328	22	105

Description	D	L	d	I	⚖	Hardness 40 Shore A			Hardness 55 Shore A			Hardness 70 Shore A					
						Code	Max load [N]	Max deflection [mm]	Stiffness [N/mm]	Code	Max load [N]	Max deflection [mm]	Stiffness [N/mm]	Code	Max load [N]	Max deflection [mm]	Stiffness [N/mm]
DVA.6-10-10-SST-M5-12-55	10	10	M5	12	2	ON REQUEST	46	3	14	410499	59	3	20	ON REQUEST	113	3	40
DVA.6-20-15-SST-M6-18-55	20	15	M6	18	9	ON REQUEST	84	5	17	410500	194	4	48	ON REQUEST	321	4	78
DVA.6-20-24-SST-M6-18-55	20	24	M6	18	10	ON REQUEST	82	6	14	410501	130	6	22	ON REQUEST	330	6	55
DVA.6-25-20-SST-M6-18-55	25	20	M6	18	15	ON REQUEST	84	5	17	410503	190	5	38	ON REQUEST	495	5	96
DVA.6-30-30-SST-M8-18-55	30	30	M8	18	24	ON REQUEST	190	8	25	410505	260	8	35	ON REQUEST	630	8	84
DVA.6-30-36-SST-M8-20-55	30	36	M8	20	39	ON REQUEST	180	9	20	410507	320	9	36	ON REQUEST	650	9	72
DVA.6-35-40-SST-M8-23-55	35	40	M8	23	45	ON REQUEST	260	10	26	410511	300	10	30	ON REQUEST	630	10	63
DVA.6-50-50-SST-M10-28-55	50	50	M10	28	110	ON REQUEST	481	13	38	410519	740	13	59	ON REQUEST	1656	13	132
DVA.6-50-61-SST-M8-28-55	50	61	M8	28	114	ON REQUEST	490	15	32	410521	600	15	39	ON REQUEST	1520	15	100
DVA.6-50-68-SST-M10-28-55	50	68	M10	28	131	ON REQUEST	490	17	29	410523	890	17	52	ON REQUEST	1950	17	115
DVA.6-70-58-SST-M12-37-55	70	58	M12	37	258	ON REQUEST	769	15	53	410551	1332	15	92	ON REQUEST	1923	15	133
DVA.6-75-89-SST-M12-37-55	75	89	M12	37	373	ON REQUEST	971	22	44	410561	1680	22	76	ON REQUEST	2328	22	105



Machine elements

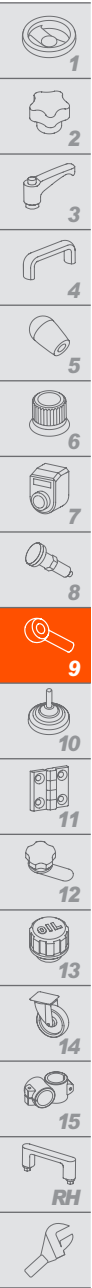

\* Complete the description with the desired hardness:  
40, 55 or 70 tolerance  $\pm 5$  Shore A.

DVA.7 - 20 - 24 - M6 - 55  
 D L d Shore A

DVA.7  
DVA.7-SST

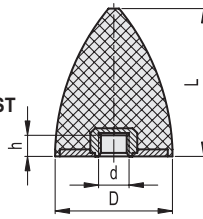

Description	D	L	d	h	⚖	Hardness 40 Shore A			Hardness 55 Shore A			Hardness 70 Shore A					
						Code	Max load [N]	Max deflection [mm]	Stiffness [N/mm]	Code	Max load [N]	Max deflection [mm]	Stiffness [N/mm]	Code	Max load [N]	Max deflection [mm]	Stiffness [N/mm]
DVA.7-10-10-M5*	10	10	M5	5	2	416271	46	3	14	413571	59	3	20	418971	113	3	40
DVA.7-20-15-M6*	20	15	M6	6	7	416297	84	5	17	413597	194	4	48	418997	321	4	78
DVA.7-20-24-M6*	20	24	M6	6	8	416301	82	6	14	413601	130	6	22	419001	330	6	55
DVA.7-25-20-M6*	25	20	M6	6	15	416307	84	5	17	413607	190	5	38	419007	495	5	96
DVA.7-30-30-M8*	30	30	M8	8	28	416311	190	8	25	413611	260	8	35	419011	630	8	84
DVA.7-30-36-M8*	30	36	M8	8	30	416321	180	9	20	413621	320	9	36	419021	650	9	72
DVA.7-35-40-M8*	35	40	M8	8	43	416331	260	10	26	413631	300	10	30	419031	630	10	63
DVA.7-50-50-M10*	50	50	M10	10	100	416337	481	13	38	413637	835	13	67	419037	1147	13	92
DVA.7-50-61-M8*	50	61	M8	8	114	416341	490	15	32	413641	600	15	39	419041	1520	15	100
DVA.7-50-68-M10*	50	68	M10	10	120	416351	490	17	29	413651	890	17	52	419051	1950	17	115
DVA.7-70-58-M12*	70	58	M12	12	230	416371	890	15	61	413671	1390	15	96	419071	1923	15	133
DVA.7-75-89-M12*	75	89	M12	12	373	416381	971	22	44	413681	1675	22	75	419081	2328	22	105

DVA.7 - 20 - 24 - SST - M6 - 55  
 D L Stainless steel d Shore A



Description	D	L	d	h	⚖	Hardness 40 Shore A			Hardness 55 Shore A			Hardness 70 Shore A					
						Code	Max load [N]	Max deflection [mm]	Stiffness [N/mm]	Code	Max load [N]	Max deflection [mm]	Stiffness [N/mm]	Code	Max load [N]	Max deflection [mm]	Stiffness [N/mm]
DVA.7-10-10-SST-M5-55	10	10	M5	5	2	ON REQUEST	46	3	14	410581	59	3	20	ON REQUEST	113	3	40
DVA.7-20-15-SST-M6-55	20	15	M6	6	7	ON REQUEST	84	5	17	410597	194	4	48	ON REQUEST	321	4	78
DVA.7-20-24-SST-M6-55	20	24	M6	6	8	ON REQUEST	82	6	14	410601	130	6	22	ON REQUEST	330	6	55
DVA.7-25-20-SST-M6-55	25	20	M6	6	15	ON REQUEST	84	5	17	410606	190	5	38	ON REQUEST	495	5	96
DVA.7-30-30-SST-M8-55	30	30	M8	8	28	ON REQUEST	190	8	25	410611	260	8	35	ON REQUEST	630	8	84
DVA.7-30-36-SST-M8-55	30	36	M8	8	30	ON REQUEST	180	9	20	410613	320	9	36	ON REQUEST	650	9	72
DVA.7-35-40-SST-M8-55	35	40	M8	8	43	ON REQUEST	260	10	26	410621	300	10	30	ON REQUEST	630	10	63
DVA.7-50-50-SST-M10-55	50	50	M10	10	100	ON REQUEST	481	13	38	410627	835	13	67	ON REQUEST	1147	13	92
DVA.7-50-61-SST-M8-55	50	61	M8	8	114	ON REQUEST	490	15	32	410631	600	15	39	ON REQUEST	1520	15	100
DVA.7-50-68-SST-M10-55	50	68	M10	10	120	ON REQUEST	490	17	29	410633	890	17	52	ON REQUEST	1950	17	115
DVA.7-70-58-SST-M12-55	70	58	M12	12	230	ON REQUEST	890	15	61	410651	1390	15	96	ON REQUEST	1923	15	133
DVA.7-75-89-SST-M12-55	75	89	M12	12	373	ON REQUEST	971	22	44	410661	1675	22	75	ON REQUEST	2328	22	105

Machine elements

744