

Type A Clamp spring washer

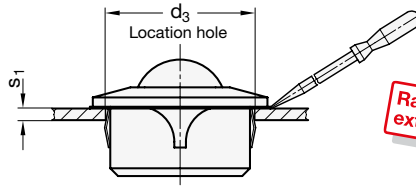

Range extended!

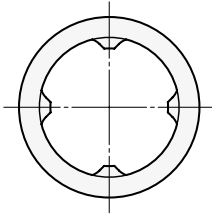
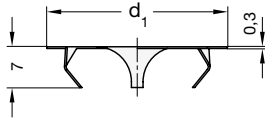

ROSTFREI
Inox
Stainless
Steel

2 Type

- A Clamp spring washer
- B Retaining ring

Type B Retaining ring

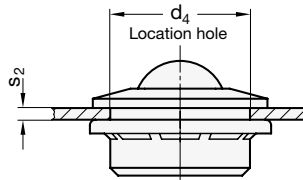
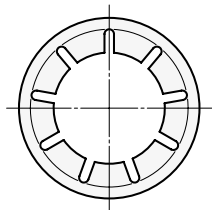
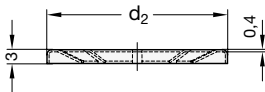

1

1

d ₁ Type A	d ₂ Type B	d ₃ Type A	d ₄ Type B Minimum dimension	S ₁ Type A	S ₂ Type B	for ball transfer units GN 509 GN 509.1 Size
-	36	-	22,2	-	optional	12
31	38	25 -0,2	24,2	2 ... 3	optional	15
44	-	37,3 -0,3	-	2 ... 4	-	22
55	-	46,7 -0,3	-	2 ... 4	-	30

Specification

- Type A
Spring steel
Stainless Steel
- Type B
Spring steel
zinc plated
- RoHS compliant

Information

Clamp spring washers GN 509.3, type A allow ball transfers units to be mounted and removed from the installation side.

Retaining rings GN 509.3, type B are mounted from the back. Ball transfers units mounted this way can no longer be dismantled. No restrictions exist with respect to sheet metal thickness.

see also...

- Ball transfer units GN 509 → Page 172

How to order GN 509.3-31-A	1 d ₁ (d ₂)
	2 Type