

# GN 426

Cabinet handles

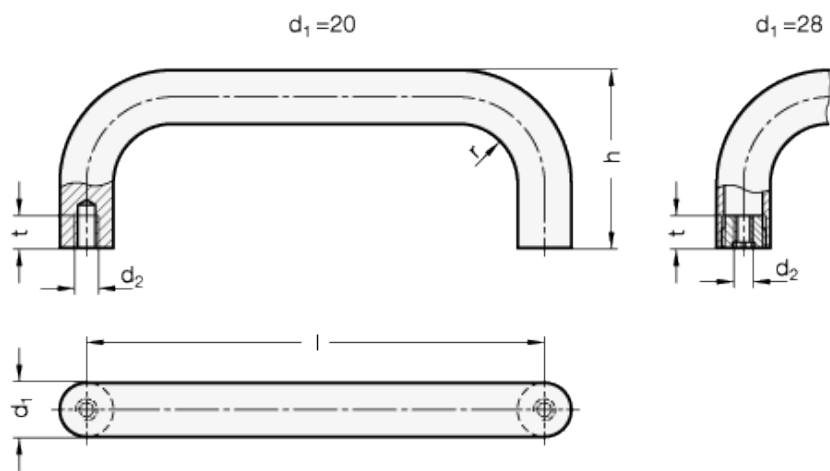

## technical informations

### Material

- Aluminium bar for  $\varnothing$  20 mm.
- Aluminium tube, thickness 4 mm for  $\varnothing$  28 mm.

### Colour

- Version BL: natural aluminium.
- Version SW: RAL 9005 black colour, matte finish, epoxy resin coating.
- Version SR: RAL 9006 silver colour, matte finish, epoxy resin coating.

### Assembly

- Tapped blind holes in the bar for  $\varnothing$  20 mm.
- Aluminium tapped bosses in the tube for  $\varnothing$  28 mm.

### Features and applications

Cabinet "U" handles GN 426 are produced from profiled aluminium extrusions.  
The manufacturing process (bending) allows the production of special lengths in relatively small quantities.

Standard Elements	Main dimensions				Mounting holes		Weight
Description	d <sub>1</sub>	l ±0.25	h	r	d <sub>2</sub>	t <sub>min.</sub>	g
GN 426-AL-20-200-SW	20	200	68	22	M8	15	240
GN 426-AL-20-200-SR	20	200	68	22	M8	15	240
GN 426-AL-20-200-BL	20	200	68	22	M8	15	240
GN 426-AL-20-250-SW	20	250	68	22	M8	15	285
GN 426-AL-20-250-SR	20	250	68	22	M8	15	285
GN 426-AL-20-250-BL	20	250	68	22	M8	15	285
GN 426-AL-20-300-SW	20	300	68	22	M8	15	320
GN 426-AL-20-300-SR	20	300	68	22	M8	15	320
GN 426-AL-20-300-BL	20	300	68	22	M8	15	320
GN 426-AL-20-350-SW	20	350	68	22	M8	15	375
GN 426-AL-20-350-SR	20	350	68	22	M8	15	375
GN 426-AL-20-350-BL	20	350	68	22	M8	15	375
GN 426-AL-28-250-SW	28	250	78	32	M10	15	290
GN 426-AL-28-250-SR	28	250	78	32	M10	15	290
GN 426-AL-28-250-BL	28	250	78	32	M10	15	290
GN 426-AL-28-300-SW	28	300	78	32	M10	15	330
GN 426-AL-28-300-SR	28	300	78	32	M10	15	330
GN 426-AL-28-300-BL	28	300	78	32	M10	15	330
GN 426-AL-28-350-SW	28	350	78	32	M10	15	375
GN 426-AL-28-350-SR	28	350	78	32	M10	15	375
GN 426-AL-28-350-BL	28	350	78	22	M10	15	375
GN 426-AL-28-400-SW	28	400	78	32	M 10	15	415
GN 426-AL-28-400-SR	28	400	78	32	M10	15	415
GN 426-AL-28-400-BL	28	400	78	32	M10	15	415



ELESA and GANTER models all rights reserved in accordance with the law. Always mention the source when reproducing our drawings.

STANDARD MACHINE ELEMENTS WORLDWIDE