

RE.F4-WEH



Mould-on polyurethane wheels
with electro-welded steel bracket
for extra-heavy loads



RE.F4-PSL-WEH

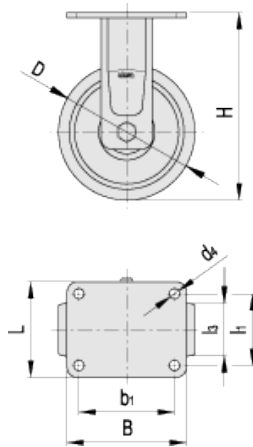

RE.F4-SSL-WEH

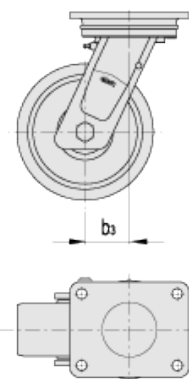

RE.F4-SSF-WEH

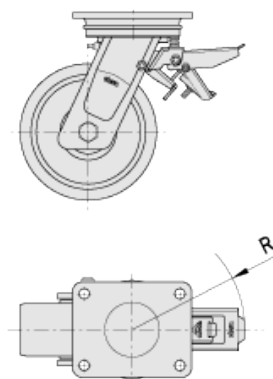

Elesa Standards		Main dimensions											Rolling resistance #	Dynamic carrying capacity #	Weight
Code	Description	D	l ₃	H	B	L	b ₁	l ₁	b ₃	R	d ₄	[N]	[N]	g	
451468	RE.F4-150-PSL-WEH	150	80	218	175	140	140	105	50	166	14	4000	10000	1215	
451469	RE.F4-200-PSL-WEH	200	80	275	175	140	140	105	65	166	14	4500	16000	1372	
451470	RE.F4-250-PSL-WEH	250	80	325	200	160	160	120	74	166	17	5000	19000	1756	
451472	RE.F4-300-PSL-WEH	300	80	365	200	160	160	120	81	166	17	6000	23000	2167	
451428	RE.F4-150-SSL-WEH	150	80	218	175	140	140	105	50	166	14	4000	10000	1215	
451429	RE.F4-200-SSL-WEH	200	80	275	175	140	140	105	65	166	14	4500	16000	1372	
451430	RE.F4-250-SSL-WEH	250	80	325	200	160	160	120	74	166	17	5000	19000	1756	
451432	RE.F4-300-SSL-WEH	300	80	365	200	160	160	120	81	166	17	6000	23000	2167	
451449	RE.F4-150-SSF-WEH	150	80	218	175	140	140	105	50	166	14	4000	10000	1215	
451450	RE.F4-200-SSF-WEH	200	80	275	175	140	140	105	65	166	14	4500	16000	1372	
451451	RE.F4-250-SSF-WEH	250	80	325	200	160	160	120	74	166	17	5000	19000	1756	
451452	RE.F4-300-SSF-WEH	300	80	365	200	160	160	120	81	166	17	6000	23000	2167	

Elesa Standards		Main dimensions								Rolling resistance #	Dynamic carrying capacity #	Weight		
Code	Description	D	I ₃	H	B	L	b ₁	I ₁	b ₃	R	d ₄	[N]	[N]	g

See [Technical Data](#) for rolling resistance and dynamic carrying capacity.

Covering

Mould-on polyurethane, hardness 95 Shore A.

Wheel centre body

Cast iron.

Hub and axle set

Hub with ball bearings. The axle set is mounted using a calibrated tube processed to obtain an even surface where ball bearings and spacers are inserted. Screw and nut are tightened to lock the spacer and the ball bearings. Ideal solution for heavy loads and continuous moving.

Standard executions

- PSL-WEH: brakeless wheel with electro-welded steel powder coating fixed plate bracket for extra-heavy loads.
- SSL-WEH: brakeless wheel with electro-welded steel powder coating turning plate bracket for extra-heavy loads.
- SSF-WEH: wheel with electro-welded steel powder coating turning plate bracket for extra-heavy loads, with brake.

Fixed plate bracket

Electro-welded steel with dark green powder coating. The bracket is designed to withstand loads up to 25000N. Suitable for heavy industrial applications and severe conditions of use, as side impact and high speeds.

Turning plate bracket

The presence of an axial bearing and a conical bearing ensures excellent manoeuvrability also at full load and increases the resistance of the support against side impact. It is equipped with lubricator and anti-loosening system of the locking nut.

The bracket is designed to withstand loads up to 25000N. Suitable for heavy industrial applications and for severe conditions of use, as side impact and high speeds.

It consists of (see fig. 1):

- 1) fitting plate: forged steel with built-in pin, dark green powder coating;
- 2) fork: drawn sides electro-welded to the flange, dark green powder coating;
- 3) Rotation system: axial ball bearing and conical roller bearing;
- 4) Lubricator;
- 5) Anti-loosening system of the locking nut.

Fig.1

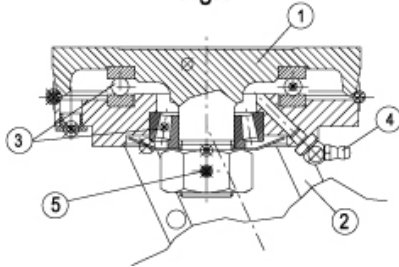

Rear-actuated brake

Dual-effect rear brake with simultaneous locking of wheel and bracket. The brake is simple and effective to use: it is actuated and released by a simple action from the top downward at the tip of two separate pedals, thus ensuring the utmost manoeuvring comfort. The braking efficacy may be adjusted with a socket head screw M8.

Applications

Suitable for heavy industrial applications and for severe conditions of use. The mould-on polyurethane wheel ensures excellent rolling resistance and elasticity, high wear and tearing resistance.

For further information see [RE_F4](#) wheel.



