

Not adjustable type

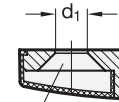

Bore for countersunk screw DIN 7991

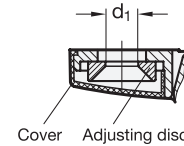
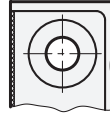

3 Type

- BJ** adjustable on both sides
- EJ** one-sided adjustable
- NJ** not adjustable

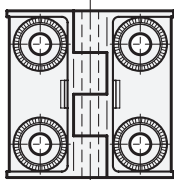

Type **BJ**

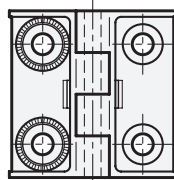

Type **EJ**

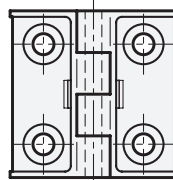

Type **NJ**

1

2

1 l_1	2 l_2	d_1	d_2	$h_{1\approx}$	$h_{2\approx}$	h_3	l_3	m_1	m_2
42	42	5,3	4	11	6,5	7,5	17	25	25
50	50	6,3	5	13,5	7	8,5	21	30	30
60	60	6,3	6	16,5	8,5	11	26	36	36

Specification

- Zinc die casting
 - plastic coated
 - black, RAL 9005, textured finish **● SW**
 - silver, RAL 9006, textured finish **● SR**
- Adjusting disc
 - Steel, hardened
- Cover
 - Plastic
 - black grey for type SW
 - light grey for type SR
- Pin
 - Stainless Steel AISI 303
- Load rating information → Page 1156
- RoHS compliant

4

Information

The adjustable hinges GN 238 allow the technically and visually perfect positioning and alignment of doors in their frames.

The steel adjusting disc has a cutting ring in its underside which cuts into the radial fins of the zinc die-cast wings when the countersunk screw is tightened, virtually creating a form-lock that prevents adjusting the hinge after mounting.

The covers conceal the fixing elements and lend the hinge an attractive optical appearance.

see also...

- Hinges GN 127 (adjustable, Zinc die casting) → Page 883

How to order

GN 238-50-50-BJ-SW

1	l_1
2	l_2
3	Type
4	Colour



Swivelling range

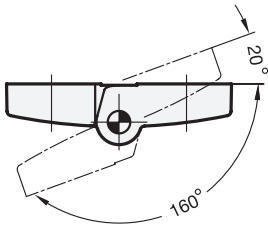

Function (Type BJ)

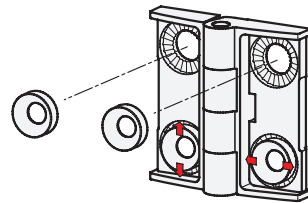

Assembly instruction

