

Example of application

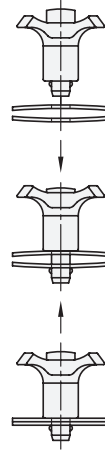

ROOSTSTAHL®
Rostfrei
Inox
Stainless
Steel

d₁ <small>-0,04 -0,08</small>	l₁ (5mm stroke) max.	min.	d₂	d₃	d₄	l₂	l₃	Locating bore H11	Clamping force max. in N ≈
6	5	0	7	38	17,5	5	30	6	16
6	10	5	7	38	17,5	5	30	6	18
8	5	0	9,5	38	17,5	6,5	30	8	16
8	10	5	9,5	38	17,5	6,5	30	8	18
10	5	0	12	47	23	8,7	36	10	21
10	10	5	12	47	23	8,7	36	10	23
12	5	0	14	47	23	9,4	36	12	21
12	10	5	14	47	23	9,4	36	12	23

Specification

- Pin
Stainless Steel AISI 303
- Handle
Plastic (Polyamide PA)
- black-grey / red
- temperature resistant up to 80 °C
- Balls
Stainless Steel AISI 420C
- Spring
Stainless Steel AISI 631
- *Stainless Steel characteristics* → Page 1144
- *Plastic characteristics* → Page 1141
- **RoHS compliant**

Accessory

- Ball chains GN 111 / GN 111.5 → Page 477
- Retaining cables GN 111.2 → Page 478
- Spiral retaining cables GN 111.4 → Page 479

Information

Stainless Steel-Ball lock pins GN 113.1 are used for rapid clamping and, at the same time, play-free clamping of thin components in particular where frequent clamping and releasing is required. A typical application is the alignment and clamping of sheet metal during a welding process.

By depressing the spring-loaded push button the pin advances by the length l_2 and at the same time frees the two balls.

see also...

- *Range of locking pins* → Page 466

How to order

GN 113.1-6-5

- 1 **d₁**
- 2 **l₁ min.**