

- 1 Type**
- DK** Operation with triangular spindle (DK7)
 - VK7** Operation with square spindle A/F7
 - VK8** Operation with square spindle A/F8
 - SCH** Operation with slot
 - VDE** Operation with double bit

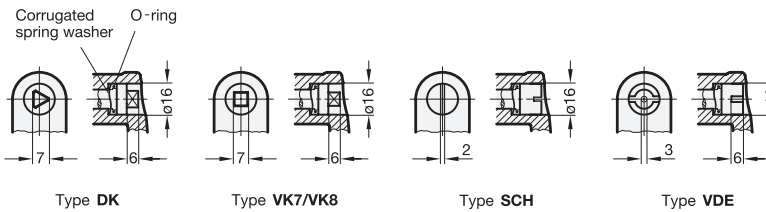

2

Latch distance A																					
4	6	8	10	13	14	16	18	20	22	24	26	28	30	32	34	36	38	40	42	45	50

Specification

- “U“ handle
Zinc die casting
plastic coated
black, RAL 9005, textured finish ● **SW**
silver, RAL 9006, textured finish ● **SR**
- other parts
Steel
zinc plated, blue passivated
- RoHS compliant

Accessory

- Key GN 119.2

Information

Latches with cabinet „U“ handles GN 115.7 are used when the application requires both a locking mechanism and a handle.

A rotary movement limited to 90°, e.g. of the triangular spindle of type DK, shifts the key-bolt behind the door frame, with the bevelled key-bolt making the door closing action easier.

The choice of 22 differently shaped catch plates gives a range A of 4 to 50 mm.

Latches GN 115.7 are supplied with loosely enclosed lock.

How to order	1 Type
GN 115.7-SCH-20-SR	2 Latch distance A
	3 Finish

Technical and assembly instructions

Depending on the installation situation, the 90° rotary movement range of the latch can be defined by means of a plug-type element which can be mounted in 4 different positions.

This allows the latch with „U“ handle to be used in any attachment position and regardless of the turning and locking direction or of the narrow side of the door. Subsequent repositioning of the 90° rotary range is possible.

The drawing below shows the plugging options and the resulting 90° rotary ranges.

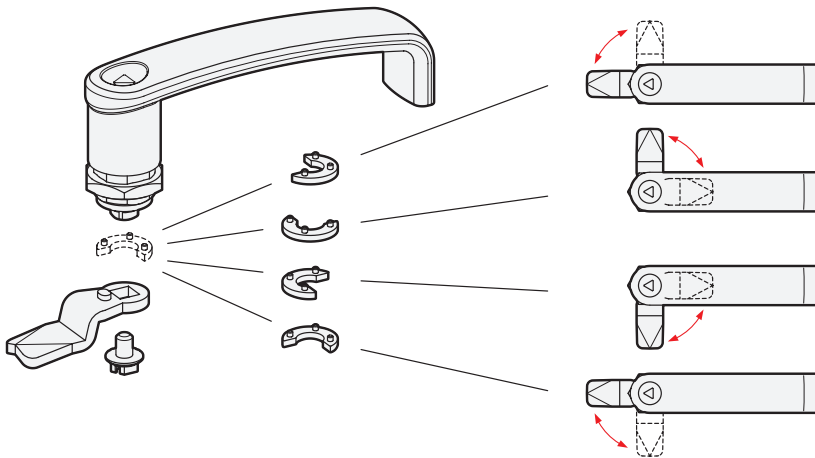

For mounting, two boreholes are drilled into the door as shown below. The spigot (M22x1.5) also has 4 surface, with the effect that the „U“ handle can also be used with the standard borehole of the latches GN 115 → *main catalogue page XYZ*.

