

# GN 927

## Clamping levers with eccentric cam

RoHS



- **Lever body**  
Zinc alloy die-cast.
- **Colour**  
RAL 9005 black matte finish, epoxy resin coating.
- **Rotation pin**  
Zinc-plated steel.
- **Tapped bushing**  
Zinc-plated steel.
- **Contact plate**
  - Type **A**: glass-fibre reinforced acetal resin based (POM) technopolymer with adjustable contact plate.
  - Type **B**: glass-fibre reinforced (PPS) technopolymer with non-adjustable contact plate.
- **Knurled base**  
Zinc-plated steel.
- **Clamping element**  
Zinc-plated steel with tapped hole.

### Features and applications

Clamping levers with eccentric cam GN 927 are used for rapid clamping and releasing operations. Hereby, contrary to a clamping operation via a thread, these levers permit a torque-free clamping.

The lever has been designed to ensure that its movement cannot exceed the max. clamping position.

There are no loose components since they are all assembled and mounted in their correct order.

The salient points of type A are as follows: the distance between the eccentric cam and the contact surface is adjustable by means of a fine threaded knurled nut. This allows the max. clamping force to be set by a simple adjustment. In addition this also allows the choice of the preferred lever position in relation to the clamping lever pin.

With these clamping levers with eccentric cam, thrusts of up to 8kN can be reached.

product  
design  
award  
2007

3

146

Clamping levers

### Constructional features (Type A) / Application example

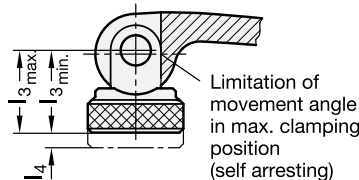
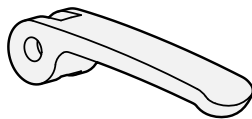

$L_3$  adjustable by the setting screw for optimum clamping force at the preferred lever position.

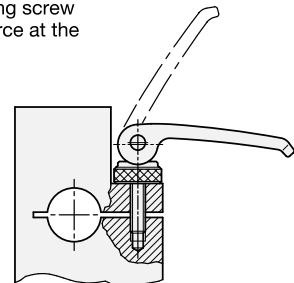

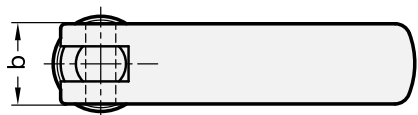
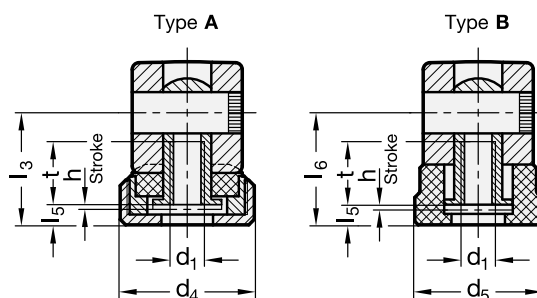
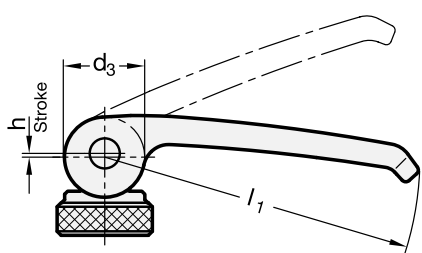

Standard Elements	Main dimensions											Mounting hole		$\Delta$
Description	$l_1$	$b$	$d_3$	$d_4$	$d_5$	$h$	$l_3$ min.	$l_3$ max.	$l_4$	$l_5$	$l_6$	$d_1$	$t$	$g$
GN 927-63-M5-A	63	16	16	19	-	0.75	16.3	18.8	2.5	3	-	M5	10	56
GN 927-63-M5-B	63	16	16	-	18.5	0.75	-	-	2.5	3	16.3	M5	10	56
GN 927-63-M6-A	63	16	16	19	-	0.75	16.3	18.8	2.5	3	-	M6	10	57
GN 927-63-M6-B	63	16	16	-	18.5	0.75	-	-	2.5	3	16.3	M6	10	60
GN 927-82-M6-A	82	20	20	25	-	1	19.5	22.5	3	3.7	-	M6	12	60
GN 927-82-M6-B	82	20	20	-	22.5	1	-	-	3	3.7	19.5	M6	12	56
GN 927-82-M8-A	82	20	20	25	-	1	19.5	22.5	3	3.7	-	M8	12	111
GN 927-82-M8-B	82	20	20	-	22.5	1	-	-	3	3.7	19.5	M8	12	98
GN 927-101-M8-A	101	25	26	30	-	1.5	25.3	29.3	4	4.8	-	M8	15	218
GN 927-101-M8-B	101	25	26	-	27	1.5	-	-	4	4.8	25.3	M8	15	200
GN 927-101-M10-A	101	25	26	30	-	1.5	25.3	29.3	4	4.8	-	M10	15	210
GN 927-101-M10-B	101	25	26	-	27	1.5	-	-	4	4.8	25.3	M10	15	200