

# GN 614.2

EXTENDED RANGE

## Double ended smooth balls spring plungers

RoHS

- **Body**  
Brass with central horizontal knurling.
- **Balls and spring**  
Hardened stainless steel balls, stainless steel spring.

### Features and applications

GN 614.2 double ended smooth balls spring plungers represent a further development of plungers type GN 614 (see catalogue 038, page 558) for special applications.

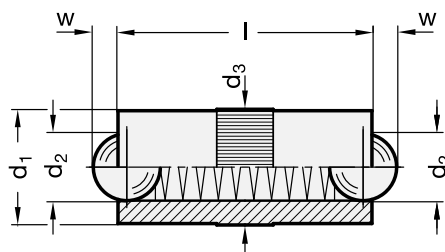
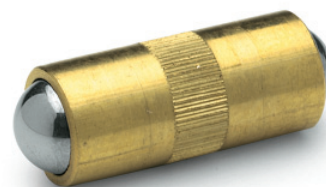

Standard Elements	Main dimensions					Spring pressure in N $\approx$		$\Delta$
	Description	d1	d2	d3 +0.05	l	w	Preload	
GN 614.2-2.5	2.5	2	2.52	5.3	0.65	1.3	2.5	1
GN 614.2-3	3	2.5	3.02	7.3	0.8	2	4.5	1
GN 614.2-4	4	3	4.03	9	0.9	2.5	7.5	1
GN 614.2-5	5	4	5.03	10.8	1.2	3.5	8	1
GN 614.2-6	6	5	6.03	12.6	1.6	3.5	10.5	2
GN 614.2-7	7	6	7.03	14	2.0	4	12	3
GN 614.2-8	8	6.5	8.03	18	2.1	6	15	5