

ELESA Original design

## Two-volume fold-away handles



### Material

Polyamide based (PA) technopolymer handle. Resistant to solvents, oils, greases and other chemical agents.

### Colour

Black, matte finish.

### Standard executions

- **IR.620**: black-oxide steel stud, sintered and oxidised steel flat base for embedded mounting, black-oxide steel screw.
- **IR.620-SST**: AISI 303 stainless steel stud, sintered AISI 303 stainless steel flat base for embedded mounting, AISI 303 stainless steel screw.



### Features and applications

Handle pivots freely during operation.

This series of fold-away handles has been designed for all those applications for which, owing to lack of space or for safety reasons, the handle must be folded-away once the operation has been completed.

Normal assembly example with embedded base

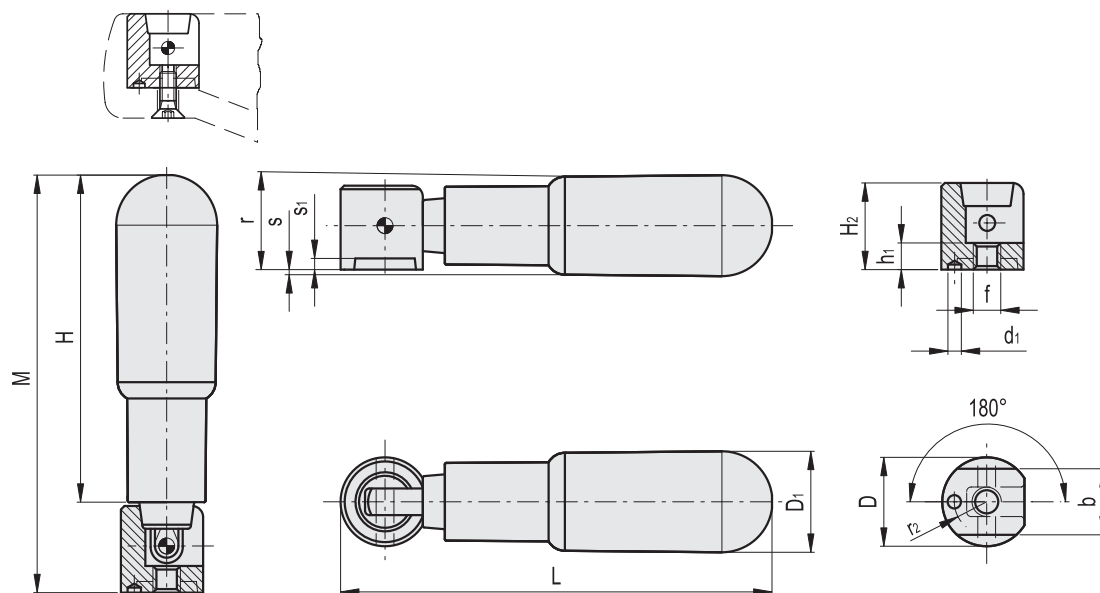

Standard Elements		Main dimensions											Mounting hole		$\Delta$	
Code	Description	H	L	M	D	D1	H2	r	s	s1	b	d1	r2	f	h1	g
128442	IR.620/45 S.D.16	45	63	60	16	15.5	14	15	0.5	1.7	10	3	5.5	M4	4	36
128444	IR.620/60 S.D.16	60	78	74	16	18	14	16.5	1.5	1.7	10	3	5.5	M4	4	38
128445	IR.620/65 S.D.16	65	89.5	80.5	16	22	14	20.5	1.5	1.7	10	3	5.5	M4	4	74
128446	IR.620/65 S.D.20	65	91.5	85	20	22	18.5	20.5	1.5	2.3	14	3	7	M6	5	78
128448	IR.620/80 S.D.20	80	106	100	20	24	18.5	21.5	2.5	2.3	14	3	7	M6	5	90
128449	IR.620/90 S.D.20	90	115.5	110	20	25	18.5	25.5	0.5	2.3	14	3	7	M6	5	118
128450	IR.620/90 S.D.26	90	119	114	26	25	23	25.5	0.5	2.3	18	3	9	M6	7	145

Standard Elements		Main dimensions											Mounting hole		$\Delta$	
Code	Description	H	L	M	D	D1	H2	r	s	s1	b	d1	r2	f	h1	g
128462	IR.620/45-SST-S.D.16	45	63	60	16	15.5	14	15	0.5	1.7	10	3	5.5	M5	4	36
128464	IR.620/60-SST-S.D.16	60	78	74	16	18	14	16.5	1.5	1.7	10	3	5.5	M4	4	38
128465	IR.620/65-SST-S.D.16	65	89.5	80.5	16	22	14	20.5	1.5	1.7	10	3	5.5	M4	4	74
128466	IR.620/65-SST-S.D.20	65	91.5	85	20	22	18.5	20.5	1.5	2.3	14	3	7	M6	5	78
128468	IR.620/80-SST-S.D.20	80	106	100	20	24	18.5	21.5	2.5	2.3	14	3	7	M6	5	90
128469	IR.620/90-SST-S.D.20	90	115.5	110	20	25	18.5	25.5	0.5	2.3	14	3	7	M6	5	118
128470	IR.620/90-SST-S.D.26	90	119	114	26	25	23	25.5	.5	2.3	18	3	9	M6	7	145