

## Tubular handles

RoHS

- **Tube**

AISI 304 stainless steel, ground matte shiny finish.  
Highly resistant to wear, scratches and chemical agents.

- **Handle shanks and tube end caps**

Polyamide based (PA) technopolymer, glass fibre reinforced.  
Temperature resistant up to 100 °C.

- **Assembly**

Back mounting, zinc-plated steel threaded bushings.

**Special executions on request** (For sufficient quantities)

Different lengths.

**Features and applications**

Tubular handles GN 666 offer an even more extensive size range for any application which require mounting from the back.

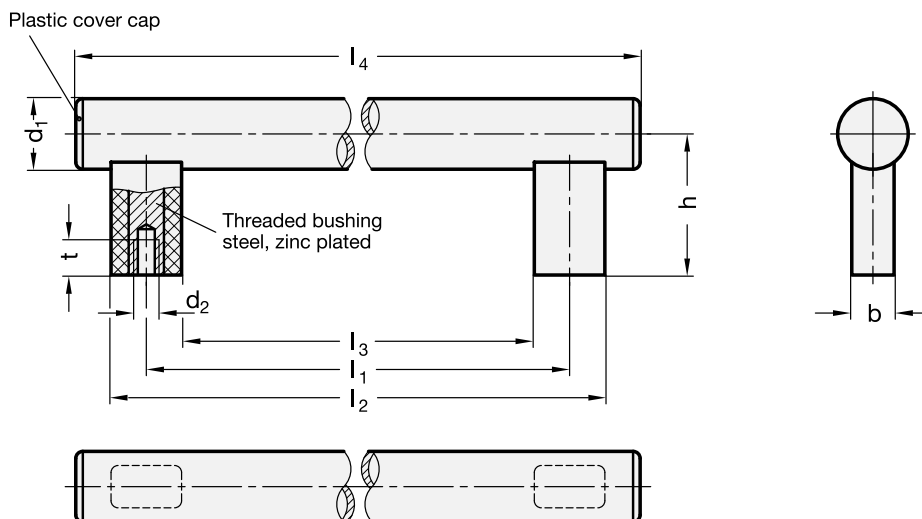

Standard Elements	Main dimensions							Mounting holes		$\Delta\Delta$
Description	d1	l1	b	h	l2	l3	l4	d2	f min.	g
GN 666-30-M6-200-NG	30	200	18	60	230	170	265	M6	12	380
GN 666-30-M6-250-NG	30	250	18	60	280	220	315	M6	12	440
GN 666-30-M6-300-NG	30	300	18	60	330	270	365	M6	12	485
GN 666-30-M6-350-NG	30	350	18	60	380	320	415	M6	12	520
GN 666-30-M6-400-NG	30	400	18	60	430	370	465	M6	12	680
GN 666-30-M6-500-NG	30	500	18	60	530	470	565	M6	12	700
GN 666-30-M6-600-NG	30	600	18	60	630	570	665	M6	12	775
GN 666-30-M8-200-NG	30	200	18	60	230	170	265	M8	15	380
GN 666-30-M8-250-NG	30	250	18	60	280	220	315	M8	15	415
GN 666-30-M8-300-NG	30	300	18	60	330	270	365	M8	15	480
GN 666-30-M8-350-NG	30	350	18	60	380	320	415	M8	15	540
GN 666-30-M8-400-NG	30	400	18	60	430	370	465	M8	15	570
GN 666-30-M8-500-NG	30	500	18	60	530	470	565	M8	15	685
GN 666-30-M8-600-NG	30	600	18	60	630	570	665	M8	15	740