

## Arch-shaped handles

RoHS

- **Tube**

AISI 304 stainless steel **NG**, ground matte shiny finish.  
Highly resistant to wear, scratches and chemical agents

- **Handle shanks and side end caps**

Glass-fibre reinforced polyamide based (PA) technopolymer, black colour, matte finish, temperature resistant up to 100 °C.

- **Assembly**

Back mounting, zinc-plated steel threaded bushings.

### Features and applications

With their curved type, GN 666.4 tubular arch handles highlight modern machine design. The production method used allows special solutions to be realised, e. g. with other radii of curvature or other leg heights.

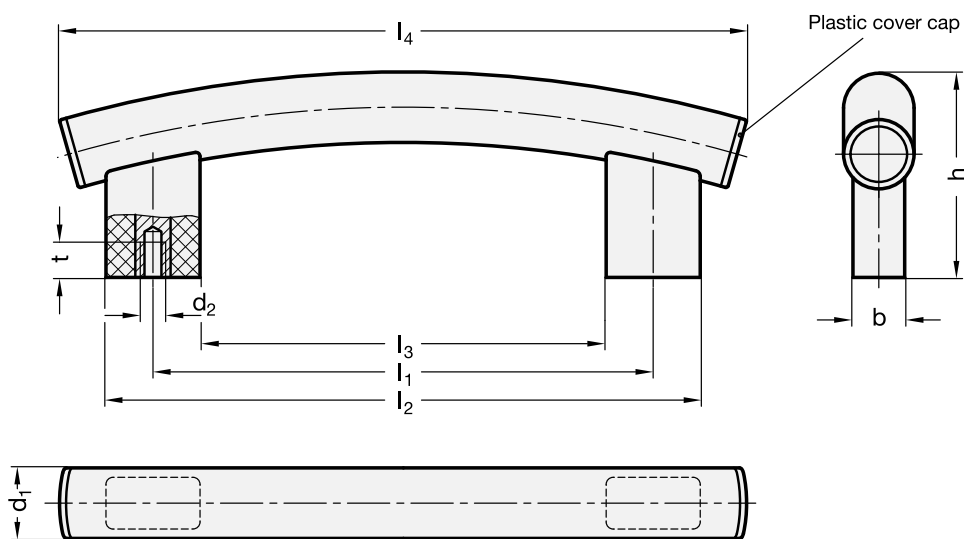

Standard Elements	Main dimensions							Mounting holes		$\triangle/\triangle$
Description	$d_1$	$l_1$	$b$	$h$	$l_2$	$l_3$	$l_4$	$d_2$	$t_{min.}$	$g$
GN 666.4-30-M6-400-NG	30	400	22	90	440	360	480	M6	15	650
GN 666.4-30-M6-500-NG	30	500	22	94	540	460	580	M6	15	780
GN 666.4-30-M6-600-NG	30	600	22	98	640	560	680	M6	15	880
GN 666.4-30-M8-400-NG	30	400	22	90	440	360	480	M8	15	618
GN 666.4-30-M8-500-NG	30	500	22	94	540	460	580	M8	15	775
GN 666.4-30-M8-600-NG	30	600	22	98	640	560	680	M8	15	850