

# GN 427

# GN 427.5

**INOX**  
Stainless Steel

## Handles

RoHS

### Material

Aluminium. Oval cross section bar.

- Version **EL**: anodised, natural colour, matte finish.
- Version **SW**: RAL 9005 black colour, matte finish, epoxy resin coating.
- Version **SR**: RAL 9006 silver, matte finish, epoxy resin coating.

### Assembly

Tapped blind holes.

### Special executions on request

(For sufficient quantities)  
Handles GN 427 are produced from profiled extrusions. The manufacturing process (bending) allows the production of special lengths in relatively small quantities.

EXTENDED RANGE

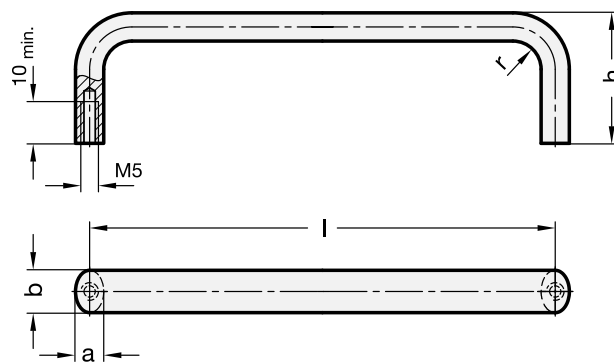
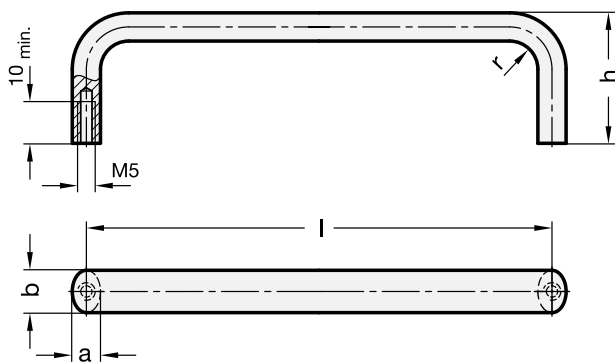

Standard Elements	Main dimensions						$\triangle$
Description	b	l $\pm 0.25$	a	h	r	g	
GN 427-12-55-*	12	55	8	40	8	26	
GN 427-12-88-*	12	88	8	40	8	30	
GN 427-12-100-*	12	100	8	40	8	30	
GN 427-12-120-*	12	120	8	40	8	35	
GN 427-12-180-*	12	180	8	40	8	45	
GN 427-12-200-*	12	200	8	40	8	50	
GN 427-12-235-*	12	235	8	40	8	60	

Standard Elements	Main dimensions						$\triangle$
Description	b	l $\pm 0.25$	a	h	r	g	
GN 427.5-12-55-NI	12	55	8	40	8	60	
GN 427.5-12-88-NI	12	88	8	40	8	80	
GN 427.5-12-100-NI	12	100	8	40	8	100	
GN 427.5-12-120-NI	12	120	8	40	8	110	
GN 427.5-12-180-NI	12	180	8	40	8	140	
GN 427.5-12-200-NI	12	200	8	40	8	150	
GN 427.5-12-235-NI	12	235	8	40	8	180	

\* Complete the description of the standard item by adding the index of the finish:  
EL (anodised, natural colour), SW (black) or SR (silver).

4

185

U-handles