

# GN 425.3

# GN 425.3-NI

**INOX**  
Stainless Steel

## Handles

RoHS

- **Material**  
Steel **ST**, sandblasted matte finish.
- **Assembly**  
Welding.

**Special executions on request** (For sufficient quantities)

Different lengths.

### Features and applications

The manufacturing process (bending) of the handles GN 425.3 allows the production of special lengths in relatively small quantities.

## Handles

RoHS

- **Material**  
AISI 304 stainless steel **NI**.  
Round cross section bar without mounting holes, sandblasted matte finish.
- **Assembly**  
Welding.

**Special executions on request** (For sufficient quantities)

Different lengths.

### Features and applications

The manufacturing process (bending) of the handles GN 425.3 allows the production of special lengths in relatively small quantities.

EXTENDED RANGE

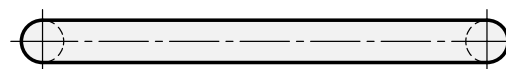
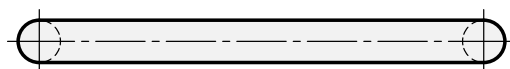
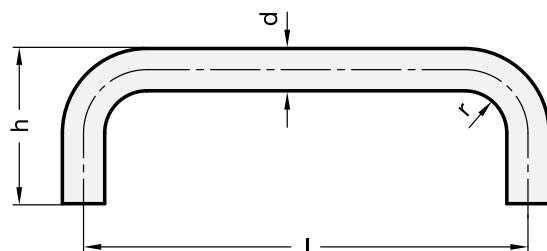
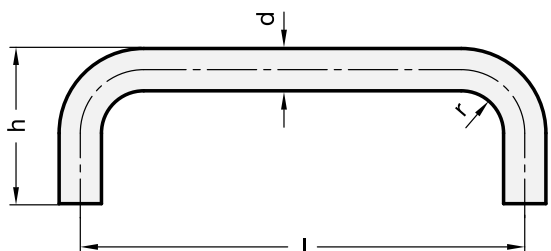

4

184

U-handles

Standard Elements	Main dimensions				⚖
Description	d	l ±0.5	h	r	g
GN 425.3-10-125-ST	10	125	43	12	110
GN 425.3-10-160-ST	10	160	43	12	130
GN 425.3-12-125-ST	12	125	51	14	170
GN 425.3-12-160-ST	12	160	51	14	210
GN 425.3-12-200-ST	12	200	51	14	245
GN 425.3-16-125-ST	16	125	59	18	320
GN 425.3-16-160-ST	16	160	59	18	370
GN 425.3-16-200-ST	16	200	59	18	440
GN 425.3-20-200-ST	20	200	68	22	700
GN 425.3-20-250-ST	20	250	68	22	830

Standard Elements	Main dimensions				⚖
Description	d	l ±0.5	h	r	g
GN 425.3-10-125-NI	10	125	43	12	115
GN 425.3-10-160-NI	10	160	43	12	137
GN 425.3-12-125-NI	12	125	51	14	175
GN 425.3-12-160-NI	12	160	51	14	210
GN 425.3-12-200-NI	12	200	51	14	245
GN 425.3-16-125-NI	16	125	59	18	245
GN 425.3-16-160-NI	16	160	59	18	380
GN 425.3-16-200-NI	16	200	59	18	450
GN 425.3-20-200-NI	20	200	68	22	715
GN 425.3-20-250-NI	20	250	68	22	840