

Double-curved handles

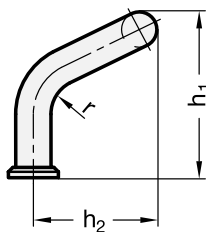

- **Material**
AISI 303 stainless steel **NI**, sandblasted matte finish.
- **Assembly**
Tapped blind holes.
- **Washers**
AISI 303 stainless steel, supplied not assembled.

Special executions on request (For sufficient quantities)
Different lengths.

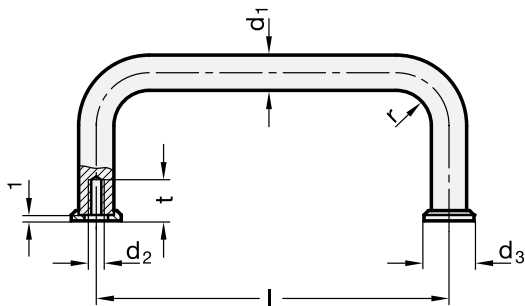

Folding handles



- **Material**
AISI 303 stainless steel **NI**, sandblasted matte finish.
- **Assembly**
Back mounting by means of two ISO 8675-M10x1 AISI 304 stainless steel hexagon nuts and DIN 125 AISI 304 stainless steel washers.
- **Stop spring**
To keep the handle open or folded back.

Features

Folding handles GN 425.2-NI are particularly suitable where minimal protrusion is required.

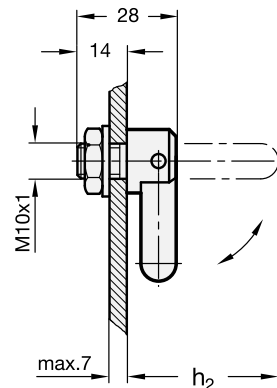
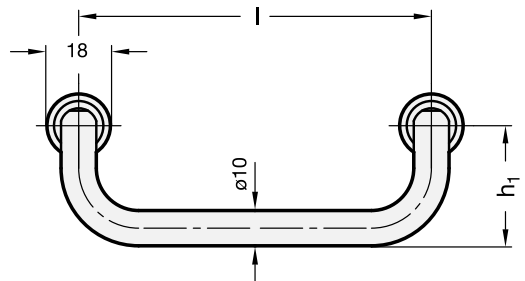

| Standard Elements | Main dimensions | | | | | Mounting holes | | | ⚖ |
|--------------------|-----------------|---------|----|----|----|----------------|----|--------|-----|
| Description | d1 | l ±0.25 | d3 | h1 | h2 | r | d2 | t min. | g |
| GN 425.1-10-88-NI | 10 | 88 | 15 | 47 | 35 | 12 | M5 | 12 | 110 |
| GN 425.1-10-100-NI | 10 | 100 | 15 | 47 | 35 | 12 | M5 | 12 | 121 |
| GN 425.1-10-120-NI | 10 | 120 | 15 | 47 | 35 | 12 | M5 | 12 | 135 |

| Standard Elements | Main dimensions | | | ⚖ |
|-------------------|-----------------|----|----|-----|
| Description | l | h1 | h2 | g |
| GN 425.2-100-NI | 100 | 34 | 28 | 152 |
| GN 425.2-120-NI | 120 | 34 | 28 | 162 |
| GN 425.2-180-NI | 180 | 34 | 28 | 200 |