

# GN 334.1

## Oval tubular handles

RoHS

- **Tube**  
Aluminium.
- **Handle shanks**  
Die-cast zinc alloy, epoxy resin coating.
- **Finish**  
Version **SW**:  
- Tube: RAL 9005 black colour, matte finish, epoxy resin coating.  
- Handle shanks: RAL 9005 black colour, matte finish, epoxy resin coating.  
Version **EL**:  
- Tube: anodised, natural colour.  
- Handle shanks: RAL 9005 black colour, matte finish, epoxy resin coating.  
Version **ES**:  
- Tube: anodised, natural colour.  
- Handle shanks: silver RAL 9006, matte finish, epoxy resin coating.
- **Tube end caps**  
Polyamide based (PA) technopolymer, light grey colour.  
Resistant to solvents, oils, greases and other chemical agents.



### Special executions on request (For sufficient quantities)

Different lengths.

### Features and applications

Oval tubular handles GN 334.1 are highly stable. The handle tube can be mounted without any further machining, allowing special lengths to be realised easily.

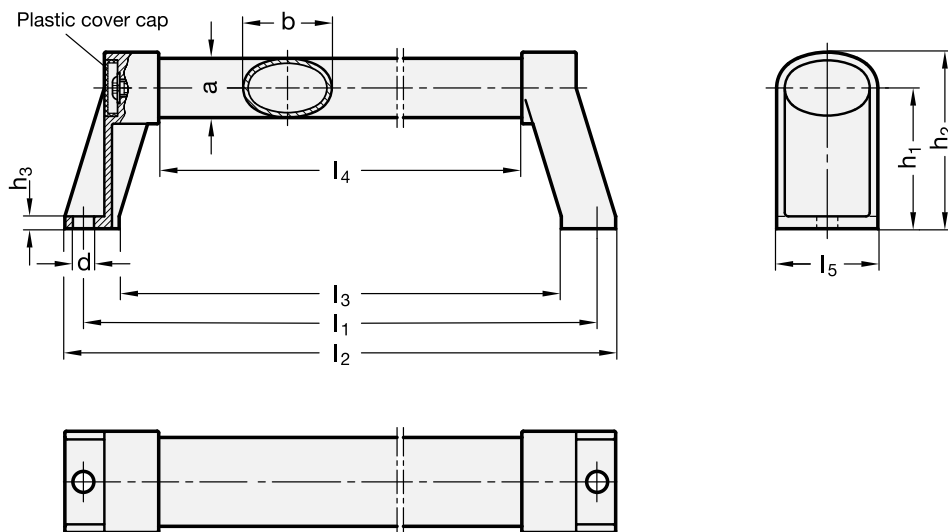

Standard Elements	Main dimensions									Mounting holes		⚖
	Description	b	$l_1 \pm 0.5$	a	h1	h2	l2	l3	l4	l5	d	
GN 334.1-36-200-*	36	200	24	57	72	215	171	139	41	8.5	5	440
GN 334.1-36-250-*	36	250	24	57	72	265	221	189	41	8.5	5	470
GN 334.1-36-300-*	36	300	24	57	72	315	271	239	41	8.5	5	500
GN 334.1-36-350-*	36	350	24	57	72	365	321	289	41	8.5	5	655
GN 334.1-36-400-*	36	400	24	57	72	415	371	339	41	8.5	5	721
GN 334.1-36-500-*	36	500	24	57	72	515	471	439	41	8.5	5	799
GN 334.1-36-600-*	36	600	24	57	72	615	571	539	41	8.5	5	878
GN 334.1-36-800-*	36	800	24	57	72	815	771	739	41	8.5	5	1043

\* Complete the description of the standard item needed by adding the index of the finish of the tube and the handle shanks: SW (black/black), EL (anodised/black) or ES (anodised/silver).