

# GN 333.8

## Handle shanks for tubular handles

RoHS

### • Handle shanks

Zinc alloy, die-cast.

- Version **SW**: RAL 9005, black colour, matte finish, epoxy resin coating.
- Version **SR**: RAL 9006, silver, matte textured finish, epoxy resin coating.

### • Assembly

Type **A**: back mounting by means of an M8 screw, tapped blind hole.

### Features and applications

For tubular handles GN 333 with handle tube  $\varnothing 28$ , type A, a handle shank GN 333.8 is available for greater handle lengths or loads.



# GN 333.9

## Handle shanks for tubular handles

RoHS

### • Handle shanks

Zinc alloy, die-cast.

- Version **SW**: RAL 9005, black colour, matte finish, epoxy resin coating.
- Version **SR**: RAL 9006, silver, matte textured finish, epoxy resin coating.

### • Assembly

Type **A**: back mounting by means of an M8 screw, tapped blind holes.

### Features and applications

For tubular handles GN 333.1 with handle tube  $\varnothing 28$ , type A, a handle shank GN 333.9 is available for greater handle lengths or loads.

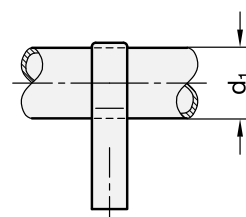
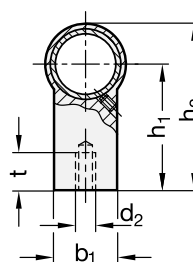
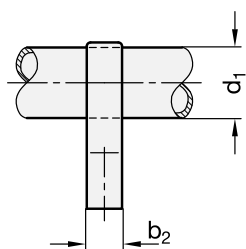
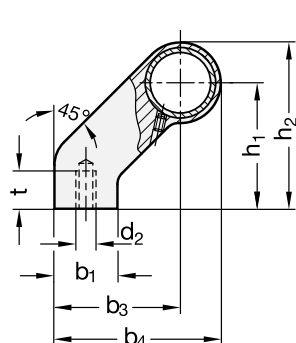

Standard Elements	Main dimensions								Mounting holes		⚖
Description	d1	b1	b2	b3	b4	h1	h2	d2	t min.	g	
GN 333.8-28-A-SW	28	25	14	50	66	50	66	M8	15	120	
GN 333.8-28-A-SR	28	25	14	50	66	50	66	M8	15	120	

Standard Elements	Main dimensions								Mounting holes		⚖
Description	d1	b1	b2	b3	b4	h1	h2	d2	t min.	g	
GN 333.9-28-A-SW	28	25	14	50	66	50	66	M8	14	90	
GN 333.9-28-A-SR	28	25	14	50	66	50	66	M8	14	90	