

EPR-SH

ERGOSTYLE®

EXTENDED RANGE

ELESA Original design

Flush pull handle assembly by means of screws



Material

Glass-fibre reinforced polyamide based (PA) technopolymer. Resistant to solvents, oils, greases and other chemical agents.

Colour

Grey-black, matte finish.

Screw cover

Technopolymer in Ergostyle colours, glossy finish, removable by a screwdriver by playing upon the central part (see drawing). Available also as accessory sold separately (see screw cover table).

Code	Description
29852-*	ECO.R2-*

* Complete with colour index (C1,.....,C6).

Standard execution

Pass-through holes for AISI 304 stainless steel self-tapping screws according to ISO 7050 Ø 2.9x9.5 mm, supplied (see Assembly instructions).

Ergonomy and design

A modern design thanks to the compact shape. The internal profile of the cavity offers a safe, comfortable and ergonomic grip. The coloured screw cover improves the visibility of the handle and offers the possibility of product customization.

Technical data

The lifting (F1) and pull out (F2) resistance values reported in the table are the result of tests carried out in laboratory with handles assembled on strengthened metal sheet panels with thickness = 1.5 mm (strengthened for test purposes).

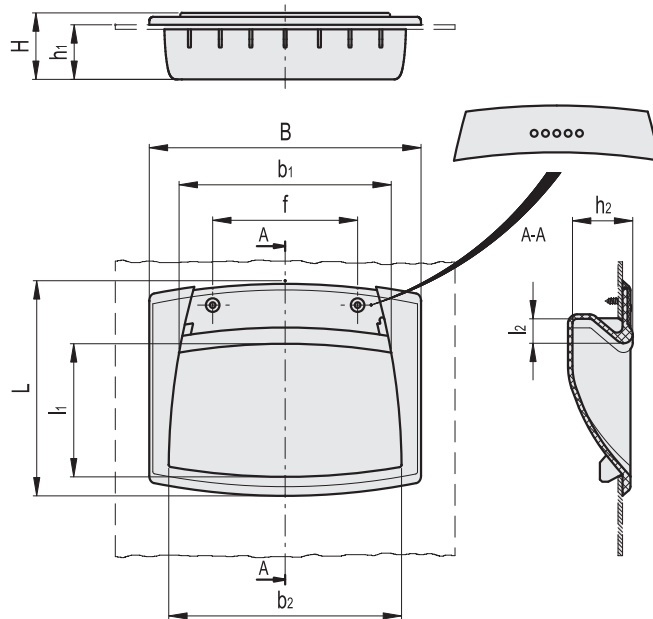
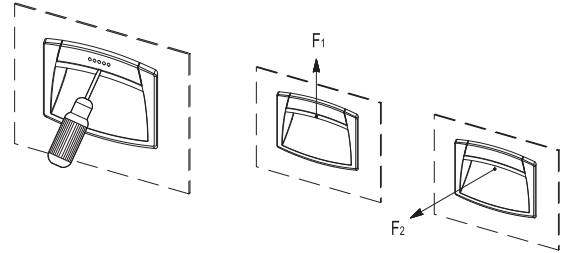

* Complete with colour index, example: 261121-C2 EPR.120-SH-C2

C1	C2	C3	C4	C5	C6
RAL7021	RAL2004	RAL7035	RAL1021	RAL5024	RAL3000

Standard Elements		Main dimensions										F1	F2	⚖
Code	Description	B	L	H	f	h1	h2	b1	b2	l1	l2	[N]	[N]	g
261091-*	EPR.110-SH-*	109	73	24	64	20	21.5	90	96	42	9	1300	500	39
261121-*	EPR.120-SH-*	120	95	28.5	64	24	26.5	94	103	58	11	1200	400	55



ELESA and GANTER models all rights reserved in accordance with the law. Always mention the source when reproducing our drawings.



Assembly instructions

1. Drill the handle housing according to the template dimensions reported in the table.
2. Remove all drilling burrs before fitting the handle.
3. Fit the upper part of the handle into the housing (Fig. 1) and press onto the lower part until firmly in place.
4. Gently push the handle downward (Fig. 2).
5. Fit the two self-tapping screws (Fig. 3).
6. Assemble the screw cover by pressing on the lateral sides first and finally on the central part (Fig. 4).

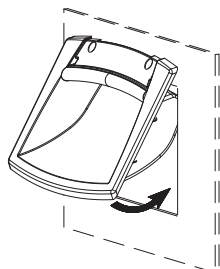

Fig.1

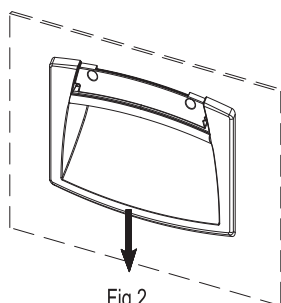

Fig.2

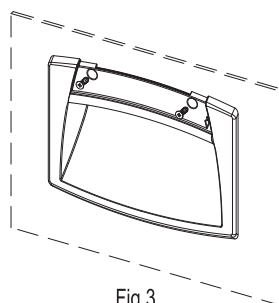

Fig.3

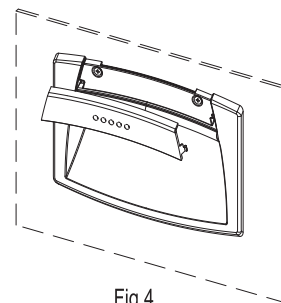
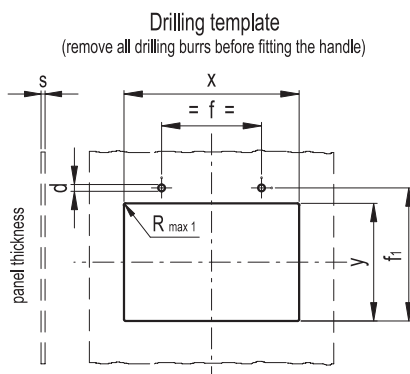

Fig.4



EPR.110-SH					EPR.120-SH				
s	x	y	f	f1	x	y	f	f1	d
1+1.2	100 ^{+0.2}	52 ^{+0.5}	64 ^{±0.1}	55.5 ^{±0.1}	107.5 ^{+0.2}	73 ^{+0.5}	64 ^{±0.1}	76.8 ^{±0.1}	2.5 ^{±0.02}
>1.2+1.5	100 ^{+0.2}	52.2 ^{+0.5}	64 ^{±0.1}	55.7 ^{±0.1}	107.5 ^{+0.2}	73 ^{+0.5}	64 ^{±0.1}	77 ^{±0.1}	2.55 ^{±0.02}
>1.5+2	100 ^{+0.2}	52.5 ^{+0.5}	64 ^{±0.1}	56 ^{±0.1}	107.5 ^{+0.2}	73 ^{+0.5}	64 ^{±0.1}	77.2 ^{±0.1}	2.6 ^{±0.02}
>2+2.5	100 ^{+0.2}	52.7 ^{+0.5}	64 ^{±0.1}	56.2 ^{±0.1}	107.5 ^{+0.2}	74 ^{+0.5}	64 ^{±0.1}	77.5 ^{±0.1}	2.65 ^{±0.02}
>2.5+3	100 ^{+0.2}	53 ^{+0.5}	64 ^{±0.1}	56.5 ^{±0.1}	107.5 ^{+0.2}	74 ^{+0.5}	64 ^{±0.1}	77.8 ^{±0.1}	2.65 ^{±0.02}
>3+3.5	100 ^{+0.2}	53.2 ^{+0.5}	64 ^{±0.1}	56.7 ^{±0.1}	107.5 ^{+0.2}	74 ^{+0.5}	64 ^{±0.1}	78.1 ^{±0.1}	2.7 ^{±0.02}
>3.5+4	100 ^{+0.2}	53.4 ^{+0.5}	64 ^{±0.1}	56.9 ^{±0.1}	107.5 ^{+0.2}	75 ^{+0.5}	64 ^{±0.1}	78.4 ^{±0.1}	2.7 ^{±0.02}
>4+4.5	100 ^{+0.2}	53.6 ^{+0.5}	64 ^{±0.1}	57.1 ^{±0.1}	107.5 ^{+0.2}	75 ^{+0.5}	64 ^{±0.1}	78.7 ^{±0.1}	2.7 ^{±0.02}
>4.5+5	100 ^{+0.2}	53.8 ^{+0.5}	64 ^{±0.1}	57.3 ^{±0.1}	107.5 ^{+0.2}	75 ^{+0.5}	64 ^{±0.1}	79 ^{±0.1}	2.7 ^{±0.02}

Drilling template

- On panels with thickness (s) exceeding 2.5 mm, we recommend you to fit the handle following one of the here-under reported ways:
- by two self-tapping screws in the bores "d";
 - by two countersunk head screws M3x6 after tapping the bores in the panel;
 - by two countersunk head screws M3x10 with nuts, after drilling blind holes Ø 3.2 mm.