

ELESA Original design

Bridge handles front mounting



Material

Glass-fibre reinforced polyamide based (PA) technopolymer. Resistant to solvents, oils, greases and other chemical agents.

Colour

Grey-black, matte finish.

Caps

Technopolymer in Ergostyle colours, matte finish; supplied not assembled, press-fit assembly, removable by a screwdriver. Available also as accessories sold separately (see caps table).

Code	Description	Caps for
29830-*	ECA.B0-*	EBP.110
29831-*	ECA.B1-*	EBP.140 EBP.150 EBP.180 EBP.200

* Complete with colour index (C1).....(C6).

Standard execution

Pass-through holes for cylindrical-head screws with hexagon socket.

Features and applications

EBP. handles with front mounting can be assembled in pairs opposed to EBP.B handles with back mounting (Fig. 1).

Technical data

Tensile stress and impact strength: F1, F2, L1 and L2 values reported in the table are the result of breaking tests carried out with the appropriate dynamometric equipment under the test conditions shown in the figure with ambient temperature.

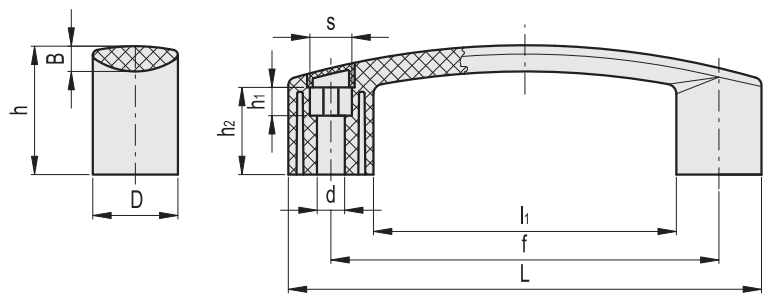
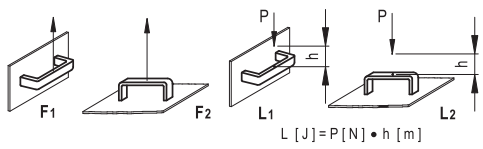

* Complete with colour index, example: 260111-C2 EBP.110-6-C2

	C1		C2		C3		C4		C5		C6
	RAL7021		RAL2004		RAL7035		RAL1021		RAL5024		RAL3000

Standard Elements		Main dimensions						Mounting holes				F1	F2	L1	L2	△/△
Code	Description	L	f	D	h	B	l ₁	d	s	h ₁	h ₂	[N]	[N]	[J]	[J]	g
260111-*	EBP.110-6-*	116	93.5±0.5	22	35	7.5	72	6.5	10	6.5	23.5	2000	1500	8	3	35
260210-*	EBP.140-6-*	144	117±0.5	26	39	8.5	92	6.5	10	19.5	26.5	2700	1800	10	4	57
260211-*	EBP.140-8-*	144	117±0.5	26	39	8.5	92	8.5	13	8.5	26.5	2700	1800	10	4	55
260251-*	EBP.150-8-*	159	132±0.5	27	42	9.5	105	8.5	13	10.5	28	2700	1800	11	4	65
260311-*	EBP.180-8-*	178	150±1	28	45	9.5	122	8.5	13	14	32	2700	1500	12	5	78
260411-*	EBP.200-8-*	208.5	179±1	28.5	51	9.5	150.5	8.5	13	16	35	2200	1500	16	9	95