

STC-A

Adjustable angle square tube connectors



- **Connector**

Polyamide (PA) based tecnopolymer.
Resistant to solvents, oils, greases and other chemical agents.

- **Colour**

Black, matte finish.

- **Standard executions**

- **2A-2W**: bidimensional two-way connector.
- **3A-3W**: tridimensional three-way connector.

Features and applications

Suitable for creating structures composed by square profiles. The assembly can be performed simply by positioning the connector, forcing it, inside the profile, with no need of screws or other fasteners.

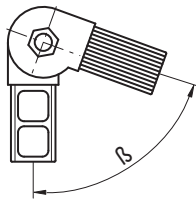

2A-2W

3A-3W

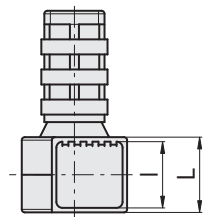
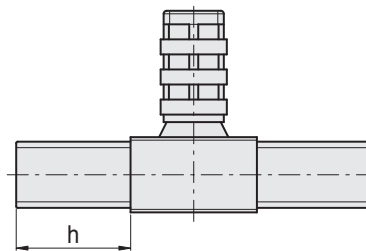
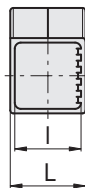
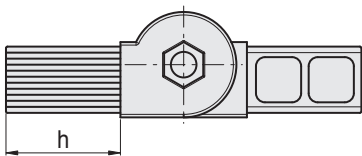

Standard Elements		Main dimensions			Tube dimensions			Rotation angle	\triangle
Code	Description	L	l	h	External	Thickness	Internal	β min-max	g
430003	STC.20-2A-2W-A-C9	20	17	35	20	1.5	17	0-190	54
430053	STC.25-2A-2W-A-C9	25	22	38	25	1.5	22	45-195	64
430103	STC.25-3A-3W-A-C9	25	22	38	25	1.5	22	45-195	85