

Round tube expander connectors



Material

Polyamide (PA) based technopolymer.
Resistant to solvents, oils, greases and other chemical agents.

Colour

Black, matte finish.

Features and applications

The two connector parts are connected together by means of two pins which are housed in special counter-seats. Two cavities inside the connector are provided for housing a hexagonal-head screw or a hexagonal nut. Thanks to the tapered shape of the cavity, the connector exerts a pressure on the inner walls of the tube, due to the tightening of the screw or of the nut, thus ensuring the tensile strength of the connection. The level of the tensile strength depends on the tube dimensional tolerances, the roughness of the tube inner surfaces and the tightening torque applied. For these reasons, it is recommended that the final user carries out the tests under real conditions of use.

The connector has no collar and allows the joining of square tubes to other elements.

The assembly can be performed simply by positioning the connector inside the tube, with no need of screws or other fasteners.

Assembly of the tube to the connector

- Hexagonal-head screw DIN 933 of dimension as shown in the table.
- Hexagonal nut DIN 934 of dimension as shown in the table.
- Self-locking hexagonal nut DIN 985 of dimension as shown in the table.

Special executions on request

Connector assembled with nut or screw.

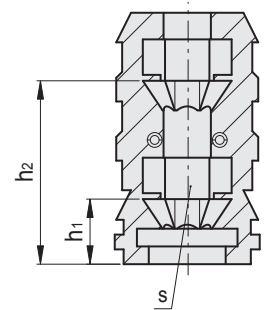
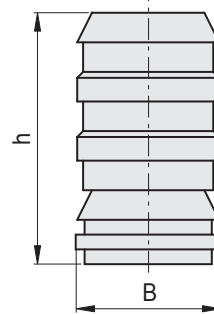

Standard Elements		Main dimensions					Tube dimensions			△△
Code	Description	B	h	h ₁	h ₂	s	External	Thickness	Internal	g
430301	RTE.20x1.0-M8	18	42	10	30	13	20	1	18	6
430303	RTE.20x1.5-M6	17	42	12	32	10	20	1.5	17	7
430305	RTE.20x1.5-M8	17	42	10	30	13	20	1.5	17	5
430311	RTE.22x1.0-M6	20	42	12	32	10	22	1	20	9
430313	RTE.22x1.0-M8	20	42	10	30	13	22	1	20	7
430321	RTE.22x1.2-M8	19.6	42	10	30	13	22	1.2	19.6	7
430323	RTE.22x1.5-M6	19	42	12	32	10	22	1.5	19	9
430325	RTE.22x1.5-M8	19	42	10	30	13	22	1.5	19	6
430331	RTE.25x1.0-M6	23	42	12	32	10	25	1	23	12
430333	RTE.25x1.5-M6	22	42	12	32	10	25	1.5	22	11
430335	RTE.25x1.5-M8	22	42	10	30	13	25	1.5	22	9
430341	RTE.28x1.5-M6	25	41	12	32	10	28	1.5	25	17
430343	RTE.28x1.5-M8	25	42	10	30	13	28	1.5	25	15
430345	RTE.28x2.0-M8	24	42	10	30	13	28	2	24	14
430351	RTE.30x1.0-M8	28	42	10	30	13	30	1	28	17
430353	RTE.30x1.5-M8	27	42	10	30	13	30	1.5	27	17
430355	RTE.30x1.5-M10	27	42	10	30	17	30	1.5	27	14
430357	RTE.30x2.0-M8	26	42	10	30	13	30	2	26	15
430359	RTE.30x2.0-M10	26	42	10	30	17	30	2	26	13
430361	RTE.32x1.2-M6	29.6	42	12	32	10	32	1.2	29.6	23
430363	RTE.32x1.5-M10	29	42	10	30	17	32	1.5	29	18
430365	RTE.32x2.0-M6	28	41.5	12	32	10	32	2	28	22
430367	RTE.32x2.0-M10	28	42	10	30	17	32	2	28	16
430369	RTE.32x2.5-M10	27	42	10	30	17	32	2.5	27	15
430371	RTE.35x1.5-M6	32	40	12	32	10	35	1.5	32	27
430373	RTE.35x1.5-M10	32	42	10	29	17	35	1.5	32	22
430375	RTE.35x2.0-M10	31	42	10	30	17	35	2	31	20
430377	RTE.35x2.5-M6	30	42	12	32	10	35	2.5	30	20
430381	RTE.40x1.5-M8	37	42	10	30	13	40	1.5	37	33
430383	RTE.40x1.5-M10	37	42	10	30	17	40	1.5	37	31
430385	RTE.40x2.0-M10	36	42	10	30	17	40	2	36	28
430387	RTE.40x2.5-M6	35	43	12	32	10	40	2.5	35	21