

Round end-caps



- **Material**
Polyamide (PA) based technopolymer. Resistant to solvents, oils, greases and other chemical agents.
- **Colour**
Black, matte finish.
- **Standard execution**
Zinc-plated steel nut DIN 934.

Features and applications

The two end-cap parts are connected together by means of two pins which are housed in special counter-seats. A cavity inside the end-cap is provided for housing an hexagonal nut DIN 934.

The assembly can be performed simply by positioning the end-cap, forcing it, inside the tube, with no need of screws or other fasteners.

Special executions on request

End-cap without nut.

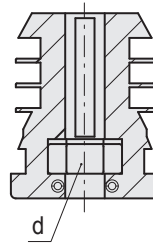
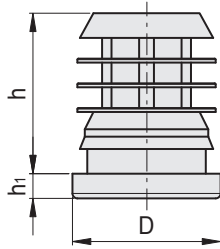

Standard Elements		Main dimensions				Tube dimensions			Max limit static load*	⚖
Code	Description	D	h	h ₁	d	External	Thickness min-max	Internal min-max	[N]	g
430651	NDL.T-20x1-1.5-M8	20	34	5	M8	20	1-1.5	18-17	3000	10
430653	NDL.T-20x2-M8	20	34	5	M8	20	2	16	3000	9
430661	NDL.T-25x1.5-2-M6	25	34	5	M6	25	1.5-2	22-21	3000	12
430663	NDL.T-25x1.5-2-M8	25	34	5	M8	25	1.5-2	22-21	3000	14
430665	NDL.T-25x1.5-2-M10	25	33	5	M10	25	1.5-2	22-21	3000	18
430667	NDL.T-25x2.5-M8	25	34	5	M8	25	2.5	20	3000	12
430671	NDL.T-28x1.5-2-M10	28	34	5	M6	28	1.5-2	25-24	3000	16
430673	NDL.T-28x1-1.5-M8	28	34	5	M8	28	1-1.5	26-25	3000	17
430675	NDL.T-28x1-1.5-M10	28	34	5	M10	28	1-1.5	26-25	3000	21
430677	NDL.T-28x2-M8	28	34	5	M8	28	2	24	3000	16
430679	NDL.T-28x2-M10	28	34	5	M10	28	2	24	3000	20
430681	NDL.T-30x1-M8	30	34	5	M8	30	1	28	3000	19
430683	NDL.T-30x1-M10	30	34	5	M10	30	1	28	3000	22
430685	NDL.T-30x1.5-2-M8	30	34	5	M8	30	1.5-2	27-26	3000	18
430687	NDL.T-30x1.5-2-M10	30	34	5	M10	30	1.5-2	27-26	3000	22
430691	NDL.T-32x1.5-2-M8	32	34	5	M8	32	1.5-2	29-28	3000	22
430693	NDL.T-32x1.5-2-M10	32	34	5	M10	32	1.5-2	29-28	3000	26
430701	NDL.T-35x1-M10	35	34	5	M10	35	1	33	3000	29
430703	NDL.T-35x1.5-2-M8	35	34	5	M8	35	1.5-2	32-31	3000	25
430705	NDL.T-35x1.5-2-M10	35	34	5	M10	35	1.5-2	32-31	3000	29
430707	NDL.T-35x2.5-M8	35	34	5	M8	35	2.5	30	3000	23
430709	NDL.T-35x2.5-M10	35	34	5	M10	35	2.5	30	3000	27
430711	NDL.T-40x1.5-2-M8	40	34	5	M8	40	1.5-2	37-36	3000	33
430713	NDL.T-40x1.5-2-M10	40	34	5	M10	40	1.5-2	37-36	3000	37
430715	NDL.T-40x1.5-2-M12	40	34	5	M12	40	1.5-2	37-36	3000	40
430721	NDL.T-50x1.5-M8	50	34	5	M8	50	1.5	47	3000	45
430723	NDL.T-50x1.5-M10	50	34	5	M10	50	1.5	47	3000	48
430725	NDL.T-50x2-M8	50	34	5	M8	50	2	46	3000	43
430727	NDL.T-50x2-M10	50	34	5	M10	50	2	46	3000	46
430729	NDL.T-50x2.5-M12	50	34	5	M12	50	2.5	45	3000	49

* The max limit static load is the value above which the load applied to the element may cause some plastic material breakage, under particular conditions of use.

Obviously, a factor that takes into consideration the importance and the safety level of the specific application must be applied to this value. The values shown in the table refer to the use of the end-cap in combination with a steel tube. The use of an aluminum tube may cause a decrease in the max limit static load equal to 25% due to possible deformations of the tube section under load.