

Adjustable hook clamps

RoHS

• Standard executions

- **TLF**: basic hook clamps.
- **TLFS**: hook clamps with security stop. RAL 3000 red technopolymer push button.

Index for material and surface treatment to add to standard executions:

- **Z**: zinc-plated steel.
- **SST**: AISI 304 stainless steel.
- **NH**: nickel-plated steel.

Special executions on request

- Hook clamps in unplated steel.
- Catch brackets in different shapes and finishes.



TLFS

TLF

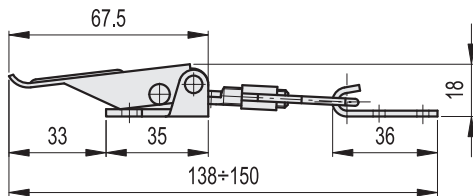

TLFS

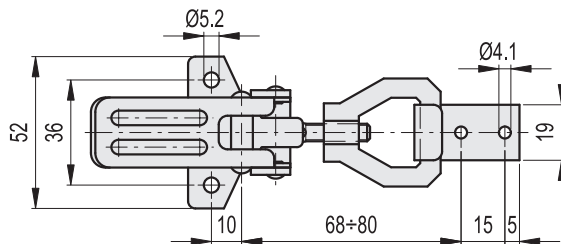
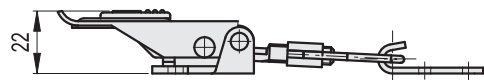

Standard Elements		Maximum working load	Load at breakage	△
Code	Description	[N]	[N]	g
420101	TLF.Z-24/138-150+R	1500	2500	101
420102	TLF.SST-24/138-150+R	1500	2500	101
420103	TLFS.NH-24/138-150+R	1500	2500	103
420104	TLFS.SST-24/138-150+R	1500	2500	103