

Spoked handwheels



Material

AISI CF-8 stainless steel, precision casting, rim turned, matte shot-blasted.

Hub

- Version **B**: H8 reamed hole.

- Version **K**: H8 reamed hole and keyway in compliance with DIN 6885/1 P9 tolerance (see catalogue 038, page A17).

For fixing GN 949-A on shafts by a grub screw see Technical Data (see catalogue 038, page A18).



Accessories on request

Axial retaining washer GN 184.5 (see catalogue 038, page 631).

Features and applications

The design of spoked Stainless-Steel handwheels GN 949-A complies with the requirements of hygiene standards.

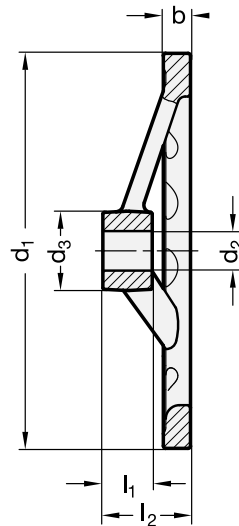
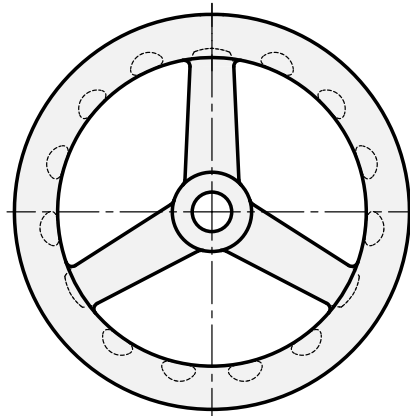

Standard Elements	Main dimensions				Bore		Spokes no.	△△ g
	d ₁	d ₃	b	l ₂ ≈	d ₂	l ₁		
GN 949-100-B10-A	100	20	7	27.5	10	15	3	220
GN 949-100-K10-A	100	20	7	27.5	10	15	3	216
GN 949-100-B12-A	100	20	7	27.5	12	15	3	220
GN 949-100-K12-A	100	20	7	27.5	12	15	3	210
GN 949-125-B12-A	125	24	9	28.5	12	16	3	430
GN 949-125-K12-A	125	24	9	28.5	12	16	3	420
GN 949-125-B14-A	125	24	9	28.5	14	16	3	430
GN 949-125-K14-A	125	24	9	28.5	14	16	3	420
GN 949-140-B14-A	140	28	10	30.5	14	18	3	610
GN 949-140-K14-A	140	28	10	30.5	14	18	3	600
GN 949-140-B16-A	140	28	10	30.5	16	18	3	610
GN 949-140-K16-A	140	28	10	30.5	16	18	3	600
GN 949-160-B14-A	160	31	11	35.5	16	20	3	825
GN 949-160-K14-A	160	31	11	35.5	16	20	3	815
GN 949-160-B16-A	160	31	11	35.5	16	20	3	825
GN 949-160-K16-A	160	31	11	35.5	16	20	3	815
GN 949-200-B18-A	200	36	14	39	18	23	3	1142
GN 949-200-K18-A	200	36	14	39	18	23	3	1132
GN 949-200-B20-A	200	36	14	39	20	23	3	1400
GN 949-200-K20-A	200	36	14	39	20	23	3	1390