

Hinges with screw-covers



EXTENDED RANGE



Material

Glass-fibre reinforced polyamide based (PA) technopolymer. Resistant to solvents, oils, greases and other chemical agents.

Colour

Black, matte finish.

Rotation pin

Acetal-resin based (POM) technopolymer, black colour.

Screw-covers

Polyester based (PBT) technopolymer, black colour, glossy finish, snap-in assembly.

Standard executions

- **CFT-SH**: pass-through holes for countersunk head screws.
- **CFT-EH**: hexagonal pass-through holes for cylindrical head screws, hexagonal head nuts or screws. CFT. hinge with boss or stud can be obtained by means of hexagonal head nuts or screws fitted into the assembly hole.

12
576

Hinges

Rotation angle (approximate value)

Max 200° (-20° and +180° being 0° the condition where the interconnected surfaces are on the same plane).

Do not exceed the rotation angle limit so as not to prejudice the hinge mechanical performance.

To choose the convenient type and the right number of hinges for your application, see the Guidelines on catalogue 038, page 792.

Special executions on request

Screw-covers in different RAL colours.

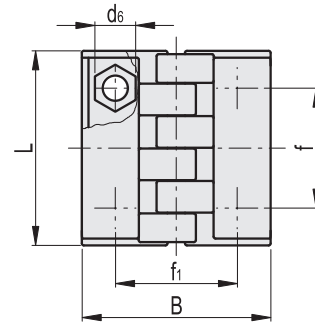
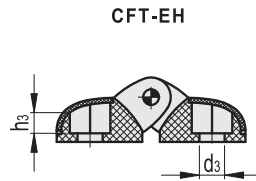
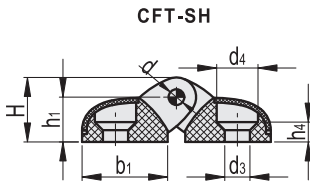
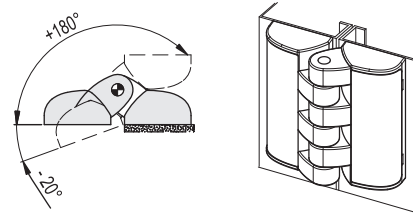

Standard Elements		Main dimensions								Fitting					⚖	
Code	Description	L	B	f ±0.25	f1 ±0.25	H	h1	b1	d	d3	d4	h3	h4	d6	C [Nm] #	g
427111-C9	CFT.40 EH-4-C9	39.5	38	25	25	13	9	17.5	3	4.5	-	4	-	7	2	11
427112-C9	CFT.40 SH-4-C9	39.5	38	25	25	13	9	17.5	3	4.5	8.5	-	4.5	-	2	11
427131-C9	CFT.49 EH-5-C9	49.5	48	30.5	31	16.5	11.5	21.5	4	5.5	-	5	-	8.5	2	24
427132-C9	CFT.49 SH-5-C9	49.5	48	30.5	31	16.5	11.5	21.5	4	5.5	10.5	-	5	-	2	24
427133-C9*	CFT.49 EH-6-C9*	49.5	48	30.5	31	16.5	11.5	21.5	4	6.5	-	5	-	10	2	24
427151-C9	CFT.65 EH-6-C9	65	63	40	40	21.5	15	29	5	6.5	-	7	-	10	2	50
427152-C9	CFT.65 SH-6-C9	65	63	40	40	21.5	15	29	5	6.5	12.5	-	7.5	-	2	50

* In case of assembly with cylindrical screw, use a shorted head screw.

Suggested tightening torque for assembly screws.

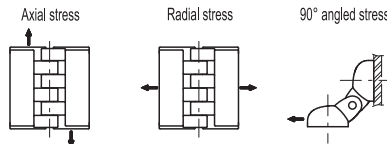

Resistance tests	AXIAL STRESS		RADIAL STRESS		90° ANGLED STRESS	
	Maximum working load Ea [N]	Load at breakage Ra [N]	Maximum working load Er [N]	Load at breakage Rr [N]	Maximum working load E90 [N]	Load at breakage R90 [N]
CFT.40	300	1500	300	1500	200	750
CFT.49	500	2900	400	3000	300	1600
CFT.65	800	4500	800	4400	500	2200