

TCD. TCDF.

ELESA Original design

Oil fill plugs



• Material

Glass-fibre reinforced polyamide based (PA) technopolymer. Resistant to solvents, oils, greases and other chemical agents.

- TCD.: without side hole.
- TCDF.: Ø 2 mm side breather hole.

• Colour

Black, matte finish.

• Flat packing ring

NBR synthetic rubber.

• Maximum continuous working temperature

130°C.

• Graphic symbol "fill"

According to DIN regulations.

Accessories on request

TCD. and TCDF. oil fill plugs are suitable for mounting MH. aluminium plates with graphic symbols (see page 955).

Technical data

An adequate tightening torque (see table below) is recommended when screwing the plug, so as to guarantee optimal tightness without any deformation of the packing ring. Suggested tightening torque is the result of laboratory tests carried out at ambient temperature (23°C) with plug, packing ring and reservoir walls perfectly cleaned.



TCD

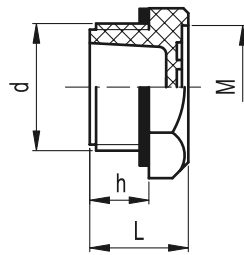

TCDF

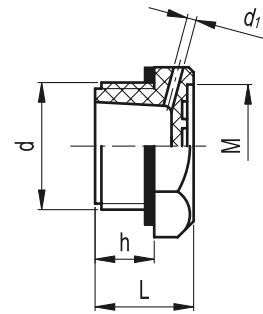

15

956

Accessories for hydraulic systems

Elesa Standards		Main dimensions					Tightening torque	⚖
Code	Description	d	h	s	L	M	[Nm]	g
58551	TCD.10x1.5	M10x1.5	9	19	16	15	4÷5	4
58553	TCD.12x1.5	M12x1.5	9	19	16	15	6÷8	4
58555	TCD.14x1.5	M14x1.5	9	19	16	15	6÷8	5
58557	TCD.16x1.5	M16x1.5	9	22	16	17	8÷10	7
58559	TCD.18x1.5	M18x1.5	11	26	18	20.5	8÷10	8
58561	TCD.20x1.5	M20x1.5	11	26	18	20.5	8÷10	8
58563	TCD.22x1.5	M22x1.5	12	32	20	25	10÷12	12
58565	TCD.25x1.5	M25x1.5	12	32	20	25	10÷12	12
58569	TCD.26x1.5	M26x1.5	12	32	20	25	10÷12	14
58567	TCD.35x1.5	M35x1.5	13	38	22	31	15÷18	15
58571	TCD.40x1.5	M40x1.5	14	46	24	38	15÷18	20

58591	TCD.1/8	G 1/8	9	19	16	15	4÷6	4
58601	TCD.1/4	G 1/4	9	19	16	15	4÷6	4
58611	TCD.3/8	G 3/8	9	22	16	17	8÷10	5
58621	TCD.1/2	G 1/2	11	26	18	20.5	8÷10	8
58631	TCD.3/4	G 3/4	12	32	20	25	10÷12	14
58641	TCD.1	G 1	13	38	22	31	12÷15	18
58643	TCD.1¼	G 1¼	14	46	24	38	15÷18	20
58645	TCD.1½	G 1½	15	55	26	46	15÷18	24

Elesa Standards		Main dimensions						Tightening torque	⚖
Code	Description	d	h	s	L	M	d ₁	[Nm]	g
58651	TCDF.10x1.5	M10x1.5	9	19	16	15	2	4÷5	4
58653	TCDF.12x1.5	M12x1.5	9	19	16	15	2	6÷8	4
58655	TCDF.14x1.5	M14x1.5	9	19	16	15	2	6÷8	5
58657	TCDF.16x1.5	M16x1.5	9	22	16	17	2	8÷10	7
58659	TCDF.18x1.5	M18x1.5	11	26	18	20.5	2	8÷10	8
58661	TCDF.20x1.5	M20x1.5	11	26	18	20.5	2	8÷10	8
58663	TCDF.22x1.5	M22x1.5	12	32	20	25	2	10÷12	12
58665	TCDF.25x1.5	M25x1.5	12	32	20	25	2	10÷12	12
58681	TCDF.26x1.5	M26x1.5	12	32	20	25	2	10÷12	14
58667	TCDF.35x1.5	M35x1.5	13	38	22	31	2	15÷18	15
58683	TCDF.40x1.5	M40x1.5	14	46	24	38	2	15÷18	20

58669	TCDF.1/8	G 1/8	9	19	16	15	2	4÷6	4
58671	TCDF.1/4	G 1/4	9	19	16	15	2	4÷6	4
58673	TCDF.3/8	G 3/8	9	22	16	17	2	8÷10	5
58675	TCDF.1/2	G 1/2	11	26	18	20.5	2	8÷10	8
58677	TCDF.3/4	G 3/4	12	32	20	25	2	10÷12	14
58679	TCDF.1	G 1	13	38	22	31	2	12÷15	18
58685	TCDF.1¼	G 1¼	14	46	24	38	2	15÷18	20
58687	TCDF.1½	G 1½	15	55	26	46	2	15÷18	24