



## Latches with fold-away knob

PA



- **Material**

Rotor, stator, fold-away knob, closing lever and nut (M22x1.5) in glass-fibre reinforced polyamide based (PA) technopolymer certified self-extinguish **UL-94 V0**. Resistant to solvents, oils, greases and other chemical agents.

- **Colour**

Black, matte finish.

- **Sealing washer**

SBR rubber.

- **Self-tapping screw**

Zinc-plated steel.

- **Rotation**

90°.

- **IP protection**

IP 65 protection class, according to IEC 529 table (see page 503).

**Special executions on request** (For sufficient quantities)

Cylindrical body of the closing lever in other dimensions.

**Technical data**

The "V0" certification in accordance with **UL-94 V (Underwriters Laboratories)** (see Technical Data on page A5) indicates that on a plastic test sample with specific shape and dimensions, in the vertical position, the flame is extinguished within 10 seconds, without generating incandescent drops.

Drilling template

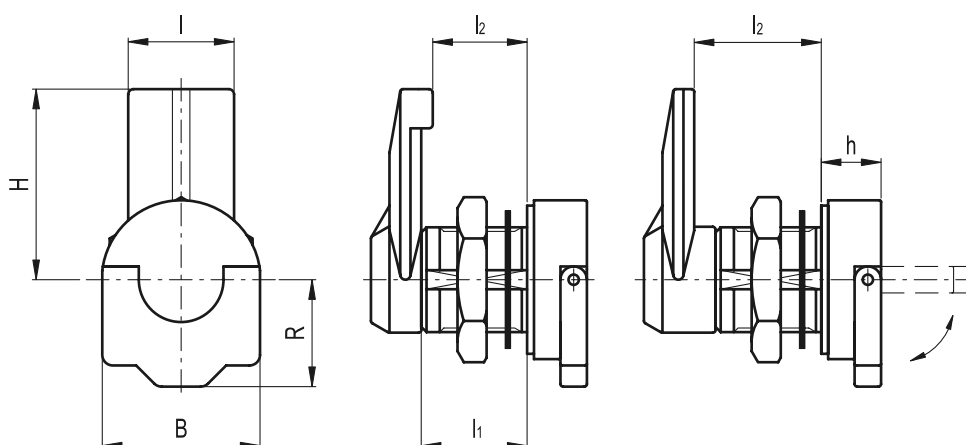
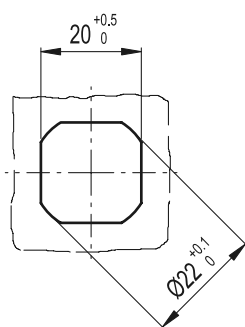

Standard Elements		Main dimensions							△
Code	Description	H	l <sub>2</sub>	B	R	h	l	l <sub>1</sub>	g
421243	CMT.32-18 AE-V0	32	18	30	20	11	20	20	27
421241	CMT.32-20 AE-V0	32	20	30	20	11	20	20	26
421245	CMT.32-24 AE-V0	32	24	30	20	11	20	20	28
421247	CMT.32-32 AE-V0	32	32	30	20	11	20	20	30